

T. 34S., R. 7W., W.M.

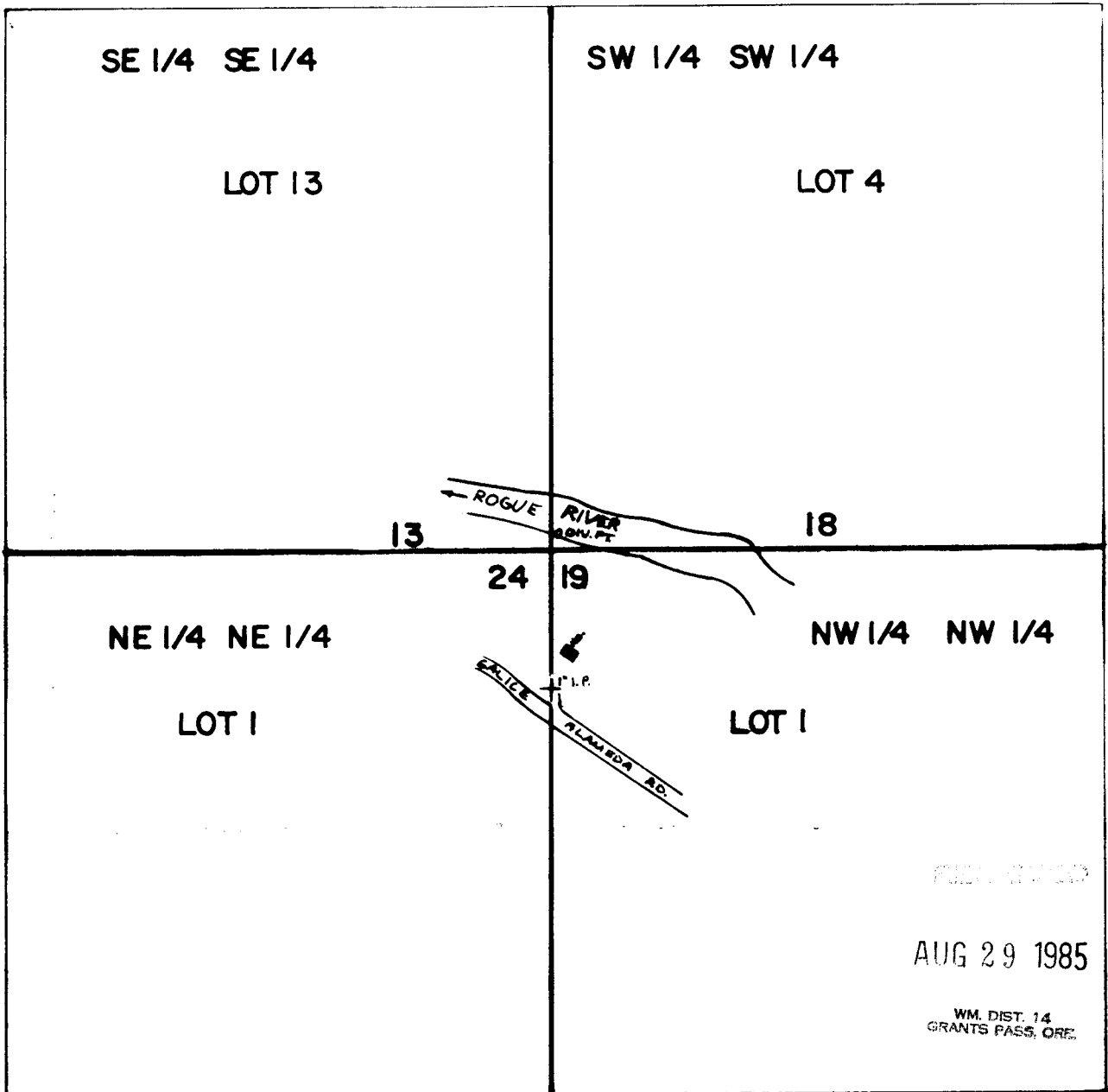

DIV. PT.: 40' N. & 15' E. FROM NW COR. SEC. 19

SCALE 1" = 400'
FINAL PROOF SURVEY
UNDER

Application No. 50419... Permit No. 38050...
IN NAME OF
MARK GORDON MINNIS

Surveyed JUNE 27 1984, by B. S. JAMES