

RECEIVED

SEP 24 1973

STATE ENGINEER  
SALEM, OREGON

# WATER RIGHT MAP

Harold F. and Alice V. Holmes

## MAP LEGEND

DIVERSION POINT - Located 1570'S and 400'W from the NE corner of Sec. 2.



.302 acre located in the SE4NE4 of Sec. 2 to be irrigated out of Prairie Creek.

■ - Building

SCALE: 1" = 660'

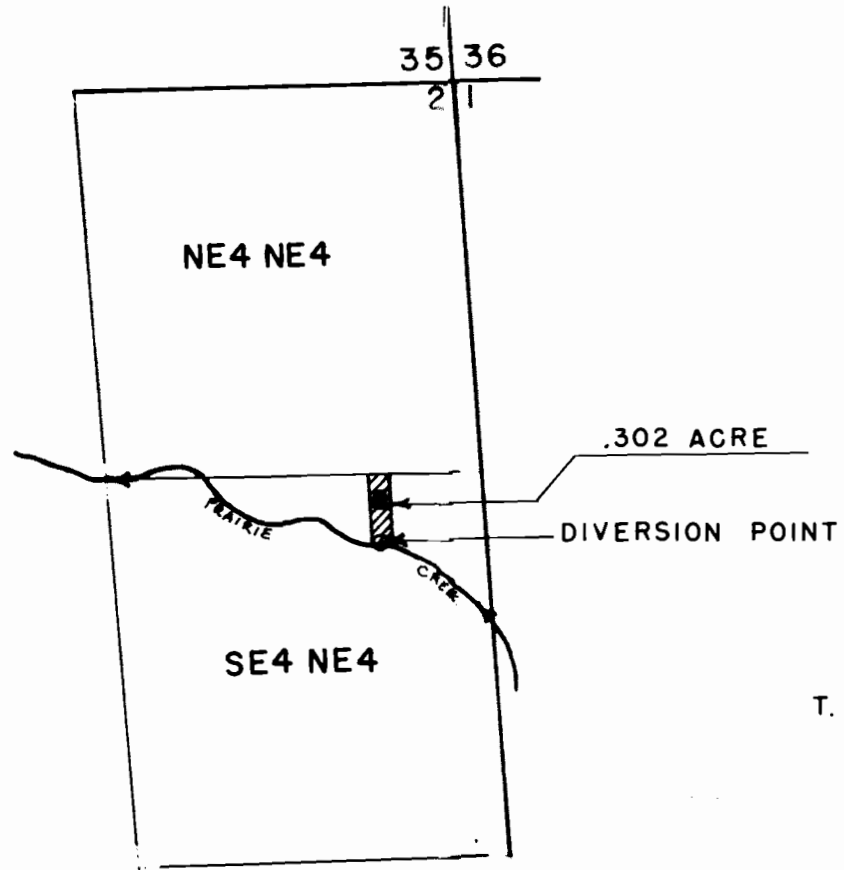

Application No. 50544  
Permit No. 38162