

T. 28S. R. 4W. W.M.

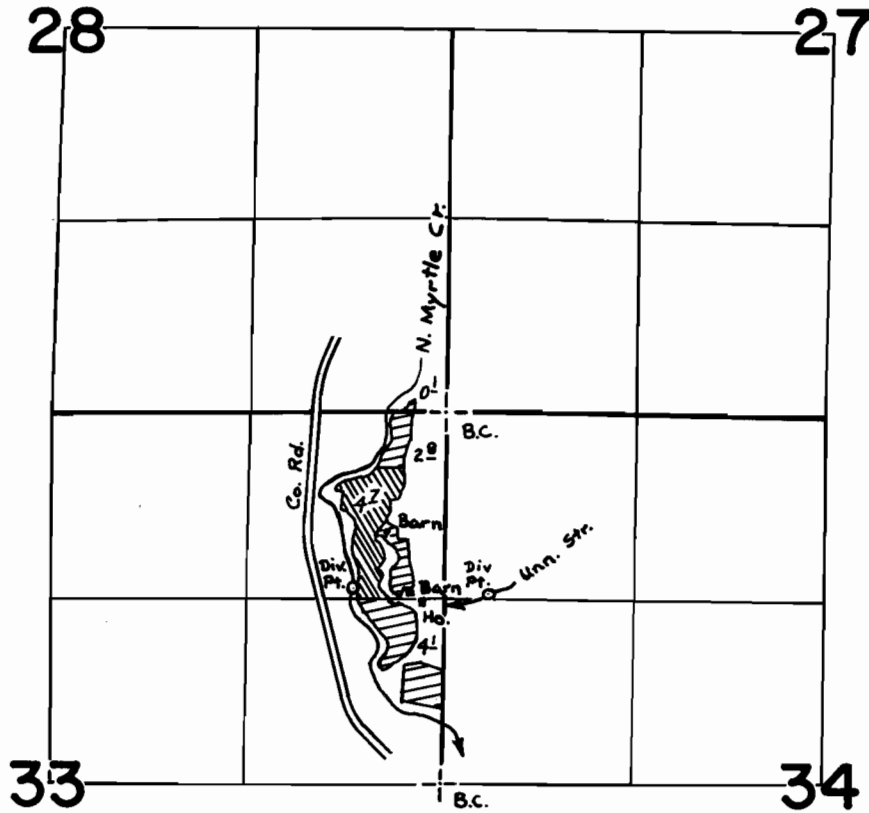

Div. Pts. Located: N. Myrtle Cr. - 1210' S & 630' W from the NE cor. of Sec. 33
 Unn. Str. - 1250' S & 300' E from the NW cor. of Sec. 34

-  Permit # 3458
-  Permit # 38450

SCALE: 4" = 1 MILE

FINAL PROOF SURVEY
 UNDER

Application No. 50928 Permit No. 38450
 IN NAME OF

ROBERT JAMES McCREARY

Surveyed Nov. 9 1978, by S. Donaldson