

T. 8 S. R. 5 & 6 W. W. M.

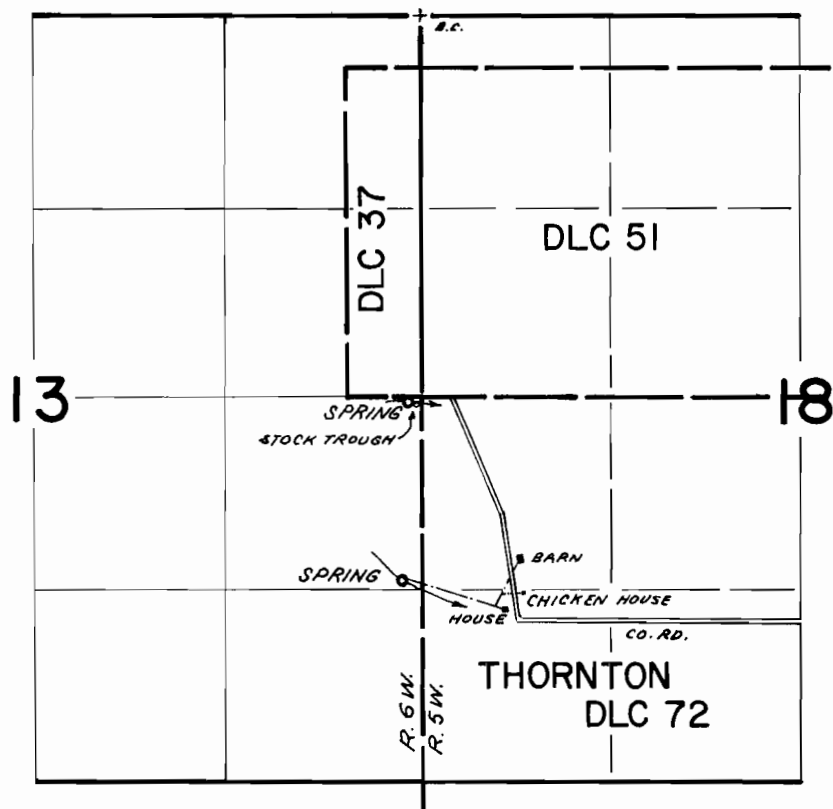

Springs Located: 2660 ft. S and 90 ft. W., and 3890 ft. S. and 140 ft. W. from NE cor. sec. 13

Application No. 51325
Permit No. 38752

Application No. _____ Permit No. _____

NEIL A. HOXIE

Surveyed November 9, 1970 , by Donald R. Buell