

T. 37 S., R. 6 W., W. M.

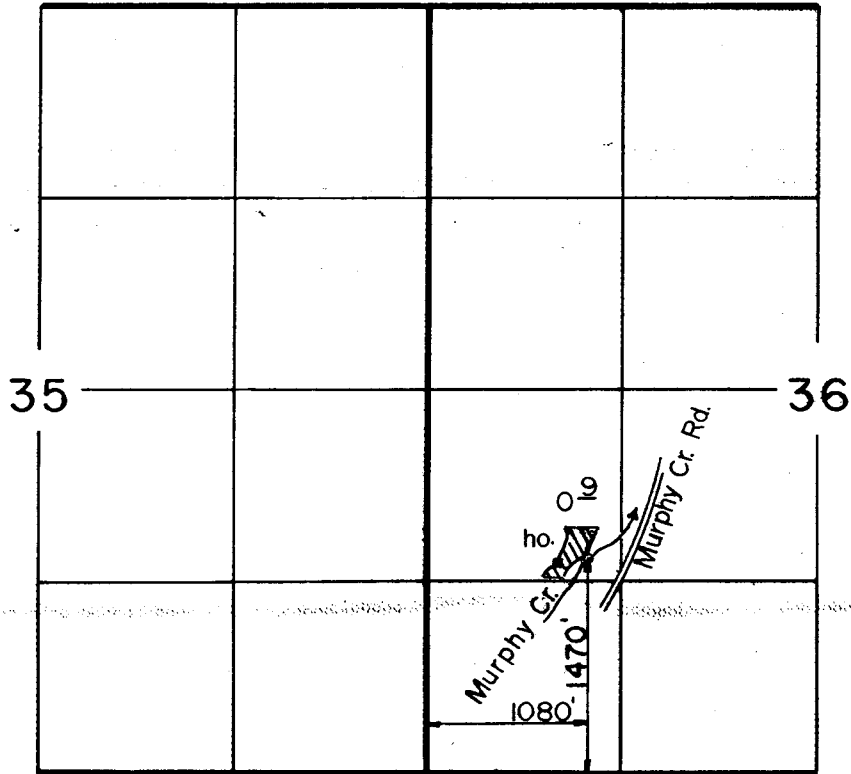

Scale: 1" = 1320'

RECEIVED
 JUL 18 1990
 WM. DIST. 14
 GRANTS PASS, ORE

FINAL PROOF SURVEY
 UNDER

Application No. 51709... Permit No. 38982...
 IN NAME OF

..... JESSE C. NELSON

Surveyed APR. 25... 1988., by B...S... JAMES....

41033-129-912
 LMS
 3/89