

T.13S., R. 30E., W.M.

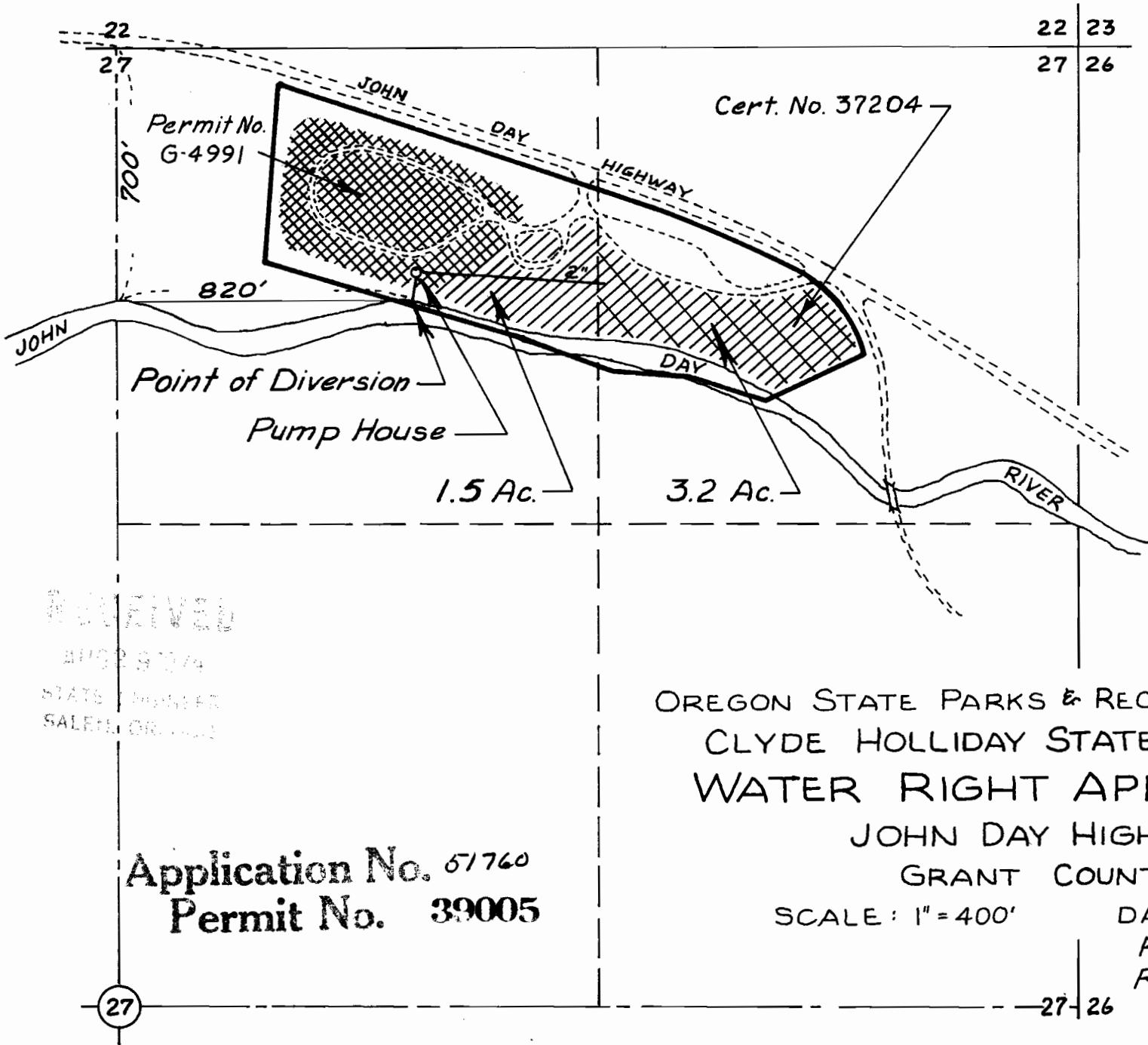

**RECEIVED**

MAR 20 1974

STATE ENGINEER  
SALEM, OREGON



**RECEIVED**

JUN 6 1974

STATE ENGINEER  
SALEM, OREGON

**RECEIVED**

MAR 28 1974

STATE ENGINEER  
SALEM, OREGON

OREGON STATE PARKS & RECREATION BRANCH  
CLYDE HOLLIDAY STATE WAYSIDE  
WATER RIGHT APPLICATION

JOHN DAY HIGHWAY

GRANT COUNTY

SCALE: 1" = 400'

DATE: 3-7-74

REV. 5-31-74

REV. 8-28-74

**Application No. 51760**  
**Permit No. 39005**

27

27-26