

R 39 E.

R 40 E, W. M., ORE.

T 8 S.

T 9 S.

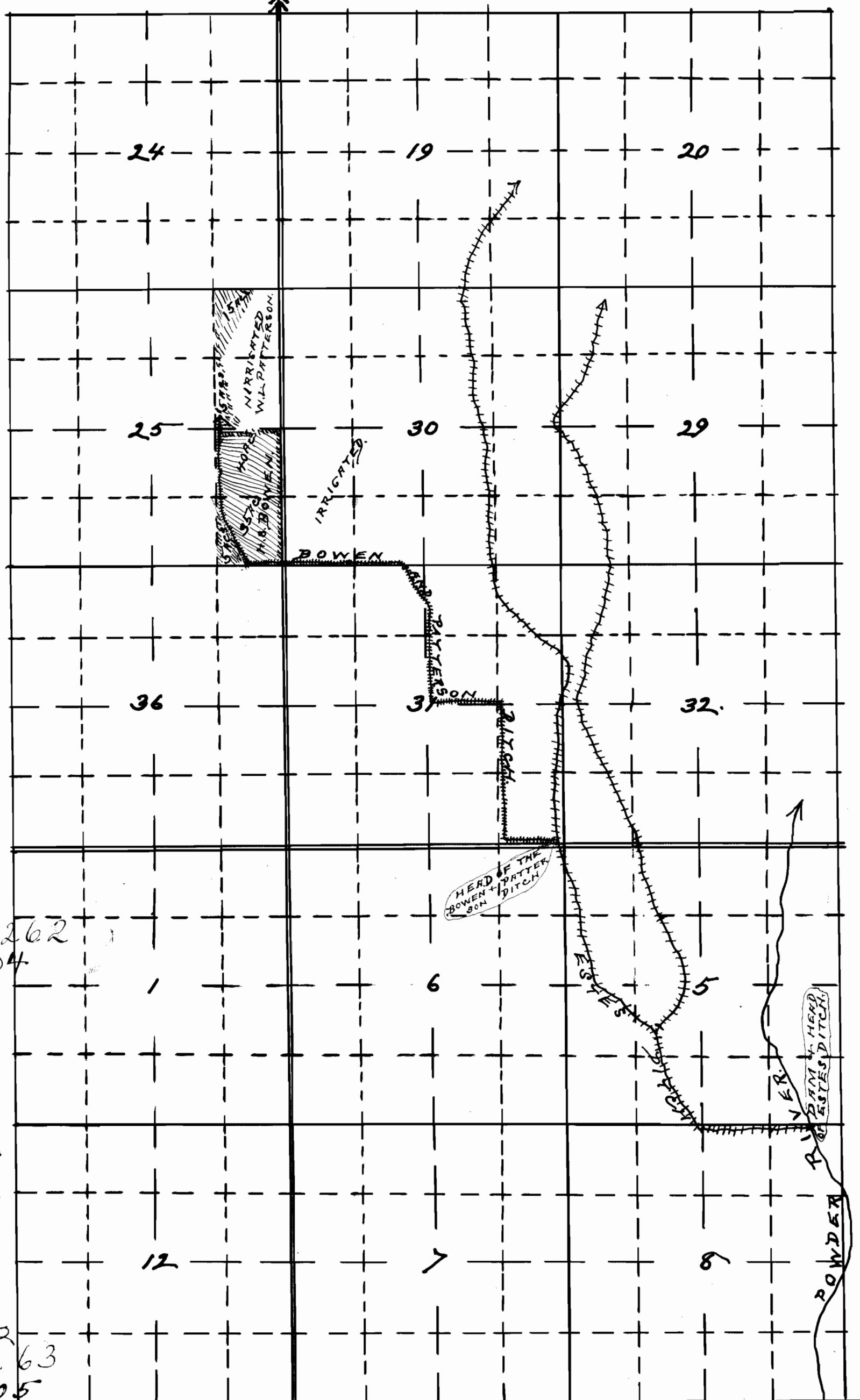

Application No. 6262  
Permit No. 3904

Application No. 6263  
Permit No. 3905

**SKETCH**  
 SHOWING  
 THE LOCATION OF LANDS  
 PROPOSED TO BE IRRIGATED  
 BY  
 H. S. BOWEN &  
 W. L. PATTERSON  
 IN SEC. 25, T 8 S, R 39 E,  
 WILL. ME., ORE.  
 SCALE, ONE INCH = 30 CHS.  
 SURVEYED AUG. 16, 1918.

Ira L. Hoffman  
 County Surveyor

**CERTIFICATE OF SURVEYOR**

I, IRA L. HOFFMAN OF BAKER,  
 ORE, HEREBY CERTIFY THAT THIS  
 PLAT WAS MADE FROM NOTES TAKEN  
 DURING AN ACTUAL SURVEY MADE ON  
 AUG. 16, 1918 & FROM A COPY OF THE  
 STATE ENGINEER'S "POWDER RIVER  
 ADJUDICATION TOWNSHIP MAPS,  
 AND THAT IT CORRECTLY REPRESENTS  
 THE WORKS DESCRIBED IN THE AC-  
 COMPANYING APPLICATIONS, TOGETH-  
 ER WITH THE LOCATION OF STREAMS  
 & OTHER DITCHES IN THE IMMEDI-  
 ATE VICINITY.

Ira L. Hoffman,  
 County Surveyor.

P 593  
 P 595