

SE 1/4 SECTION 28, T29S, R11W, WM

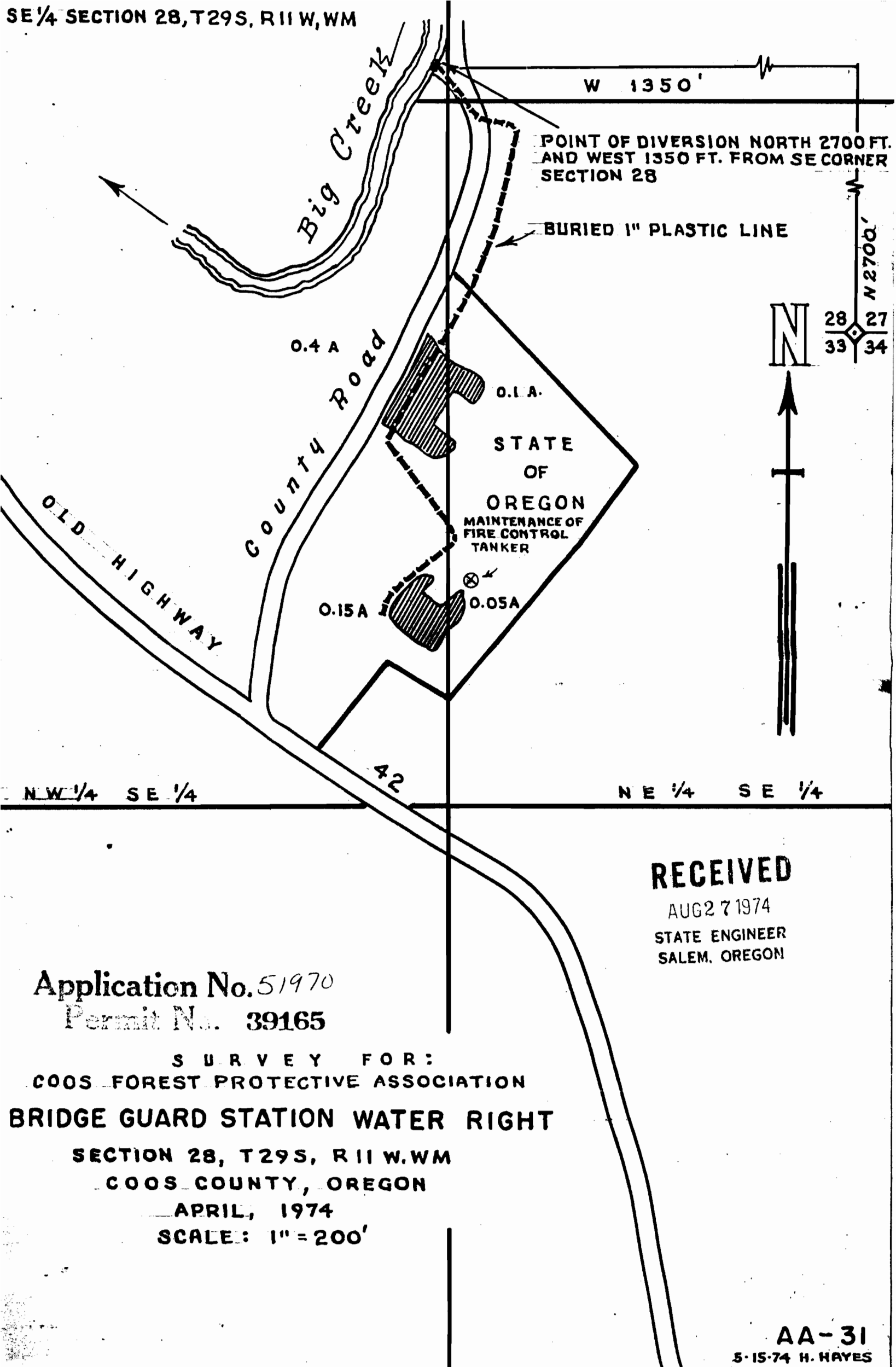

NW 1/4 SE 1/4

NE 1/4 SE 1/4

RECEIVED
 AUG 27 1974
 STATE ENGINEER
 SALEM, OREGON

Application No. 51970
 Permit No. 39165

SURVEY FOR:
 COOS FOREST PROTECTIVE ASSOCIATION
BRIDGE GUARD STATION WATER RIGHT
 SECTION 28, T29S, R11W, WM
 COOS COUNTY, OREGON
 APRIL, 1974
 SCALE: 1" = 200'

AA-31
 5-15-74 H. HAYES