

R12E

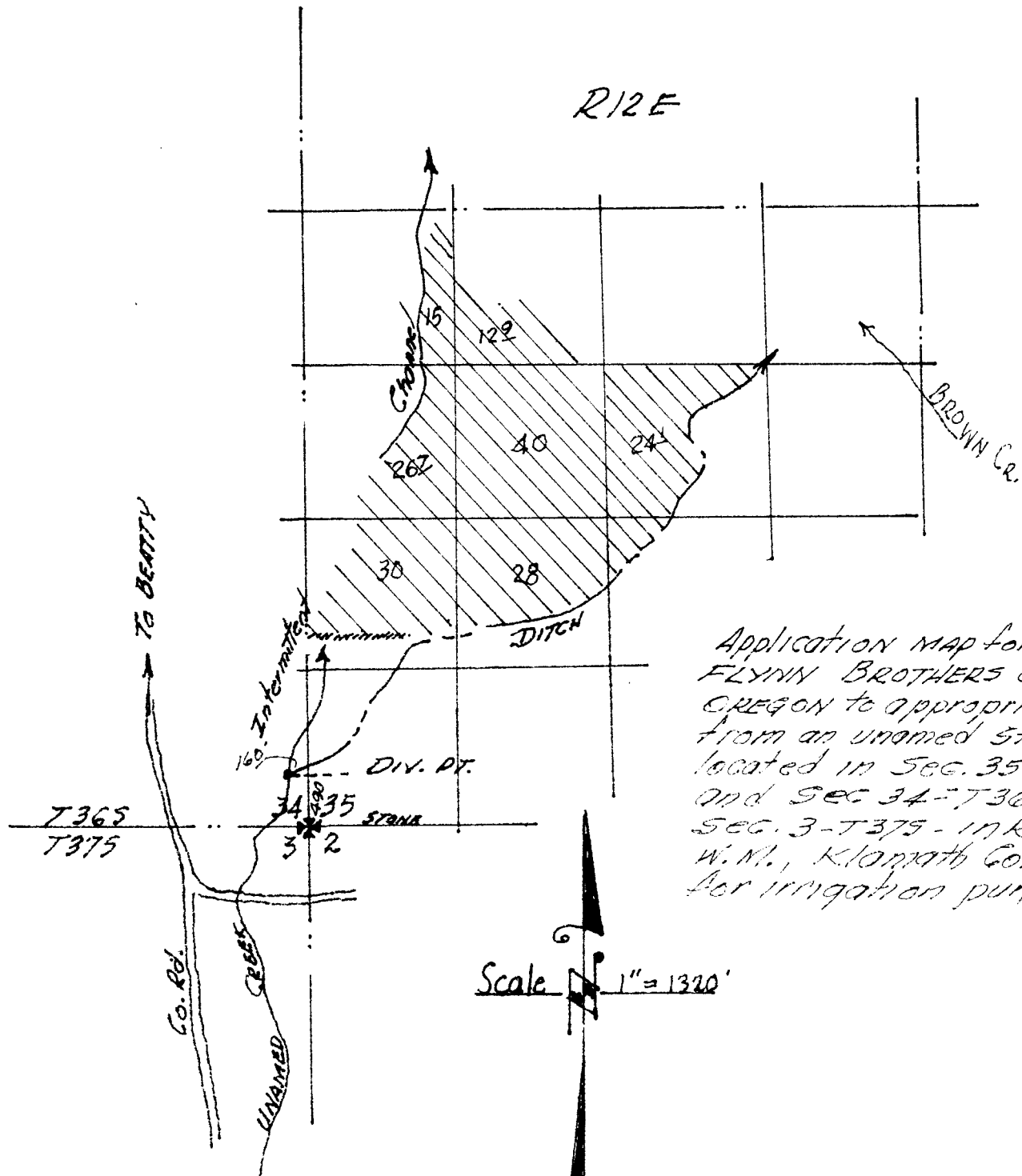

Application map for FLYNN BROTHERS of PLUSH OREGON to appropriate waters from an unnamed stream, located in SEC. 35 - T365, and SEC. 34 - T365, and SEC. 3 - T375 - in Range 12E W. 11., Klamath Co. Oregon, for irrigation purposes.

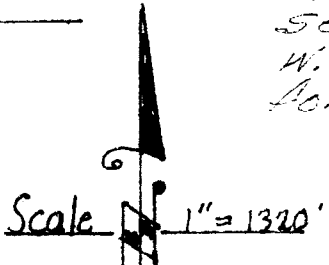

Application No. 52803
Permit No. 39181