

T. 36 S., R. 6 W., W.M.

RECEIVED  
JUL 15 1980  
DIST. 14  
GRANTS PASS, ORE

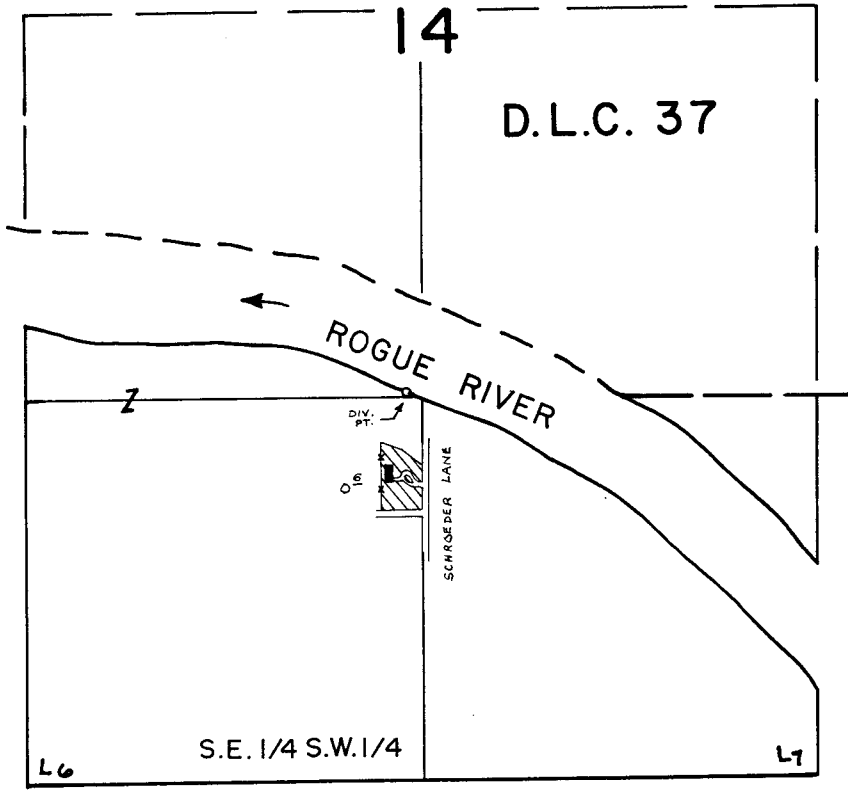

DIV. PT. LOC.: 1335' N. & 50' W. FROM S. 1/4 COR. SEC. 14.

SCALE : 1" = 660'ft.

**FINAL PROOF SURVEY**  
UNDER

Application No. 52073 Permit No. 39240  
IN NAME OF

Walter R. & Leona A. Gehlking

Surveyed NOV. 8 1977, by B. SUND

D.H.M.  
P.T.S. - 1977-14 - B