

— MAP —

Accompanying application of Dan Neathammer for Permit to appropriate The waters of Evans Creek tributary of Rogue River Jackson County, Oregon.

— November 1917. —

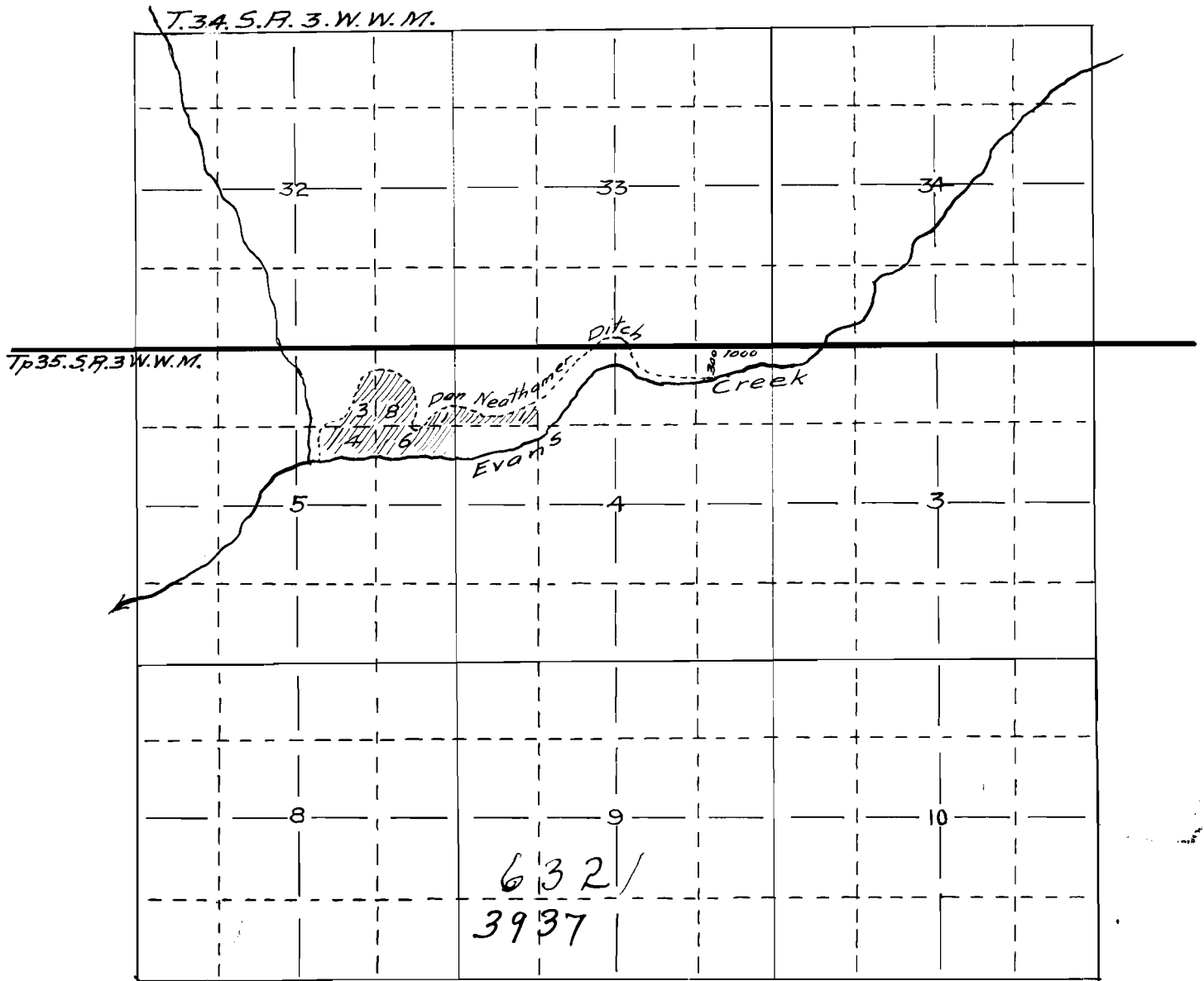

Map made from notes of actual survey of Lands and Ditch correctly showing same and ditches, & streams in immediate vicinity.

— Fred. N. Cummings C.E. —