

# WATER RIGHT SURVEY FOR ROY MAST, IN PORTIONS OF SW $\frac{1}{4}$ SW $\frac{1}{4}$ , SECTION 33, TOWNSHIP 24 SOUTH, RANGE 11 WEST, W.M. Coos County, Oregon

**RECEIVED**

MAR 25 1975

STATE ENGINEER  
SALEM, OREGON

NOTE: Estimated spring flow -  
 summer low  $\frac{1}{2}$  gallon per minute  
 winter high 2 gallons " "

Point of diversion is  
159.37 feet North  
and 356.80 feet east  
of section corner

Point of diversion is an  
un-named spring, hand dug.

70 gallon wood tank  
fed by 1" line.

Approximate  
water line  
location

Approximate Location  
of House

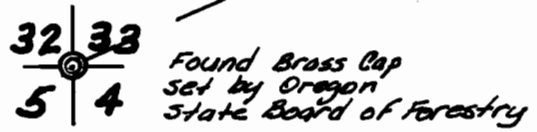

NOTE: Bearings based on  
solar observation

**Legend**

- Corner Found
- Water Lines
- Scale 1" = 60'

N65°55'53"E  
390.77 Feet  
point of diversion To

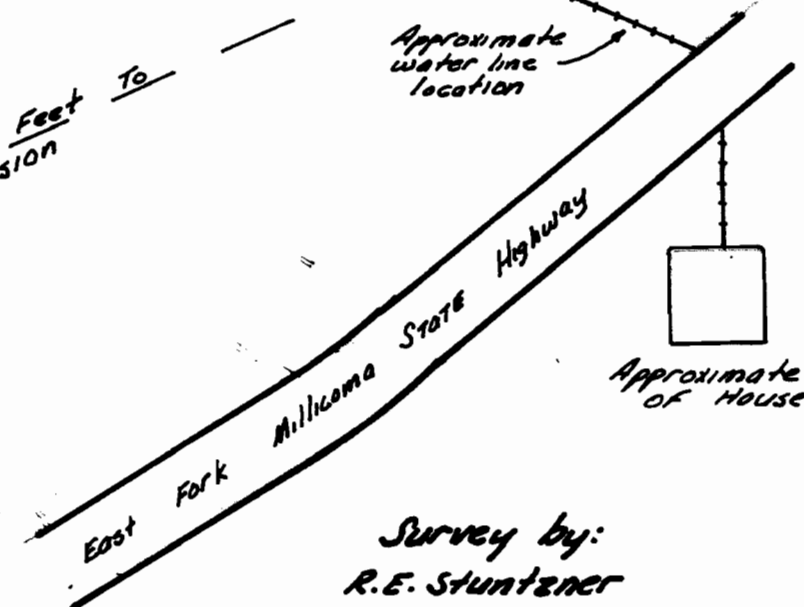

Survey by:  
R.E. Stuntzner  
1260 Golden  
Coos Bay, Ore.  
November 1, 1974



Application No. 52732  
Permit No. 39708