

Application No. 53417
Permit No. 39751

VIEW TERRACE

N.W. 1/4 N.W. 1/4 SEC. 24 T. 19S. R. 12 W. W.M.

LANE COUNTY OREGON

SCALE 1" = 100'

N.

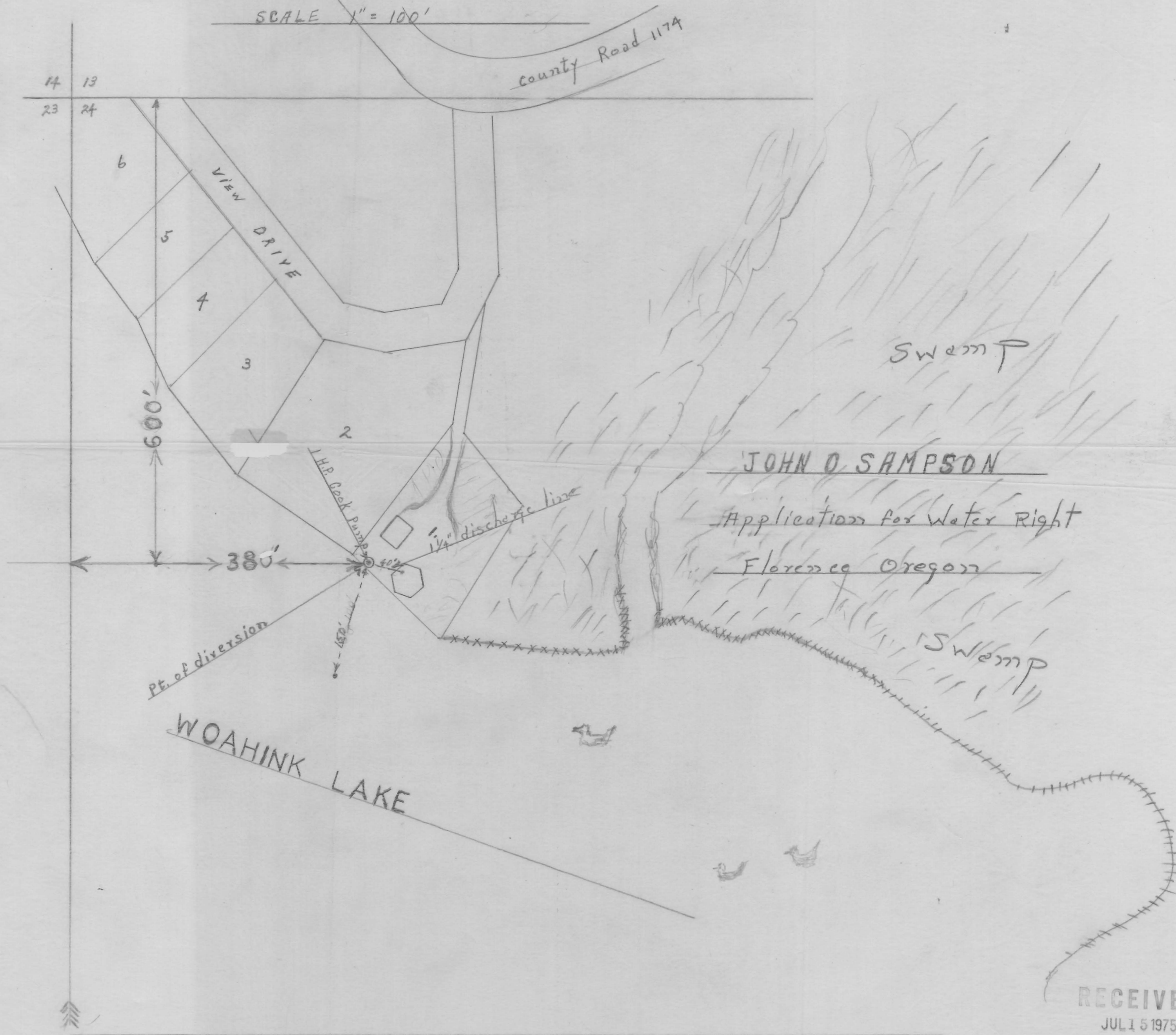

JOHN O. SAMPSON

Application for Water Right

Florence Oregon

RECEIVED

JUL 15 1975

WATER RESOURCES DEPT.
SALEM, OREGON

H.C. Sauter Reg. C.E.