

T.39 S., R.5 W., W.M.

RESERVOIRS LOCATED: *1- 570' S. & 240' E.,
 *2- 2000' S. & 830' E., BOTH
 FROM NE COR., NW 1/4 NE 1/4, SEC. 10.

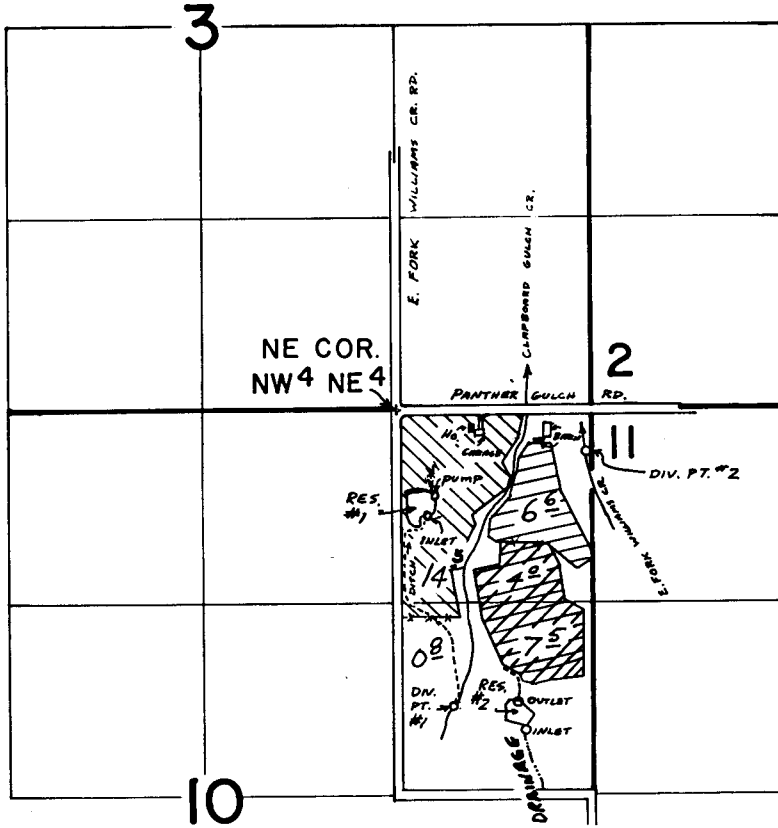



AUG 3 1987

W.M. DIST. 14
 GRANTS PASS, OK.

DIV. PTS. LOCATED: *1 - 2030' S. & 350' E.



*2 - 290' S & 1290' E., BOTH

FROM NE COR., NW 1/4 NE 1/4, SEC. 10.

-  Res *1 Permit 39935
-  Res *2 " "
-  Permit 40135

FINAL PROOF SURVEY

UNDER

-  PRIMARY R-51671 R-6392
 51672 39935
-  SUPPLEMENTAL Application No. 53677.. Permit No. 4035.. 40135

IN NAME OF

.....GEORGE.....BRETZ.....

Surveyed Oct. 3, 1980, by BRUCE R. SUND

Scale: 4" = 1 mile

PTS-1980-14B

PTS-1979-14A

BSJ