

Stones & Post (F.S.)
2-19-68 B.C. in 1969

1317.36 N. 89°54'W.

IRON PIPE
B.C. 1970

NW Cor. Sec. 25

NE 1/4 NW 1/4
Sec. 25
T. 55 R. 9 W. 1/4 M.

Blow up of Circled Sec.
of Map 1

Scale 1" = 200.00'

MAP 2

N

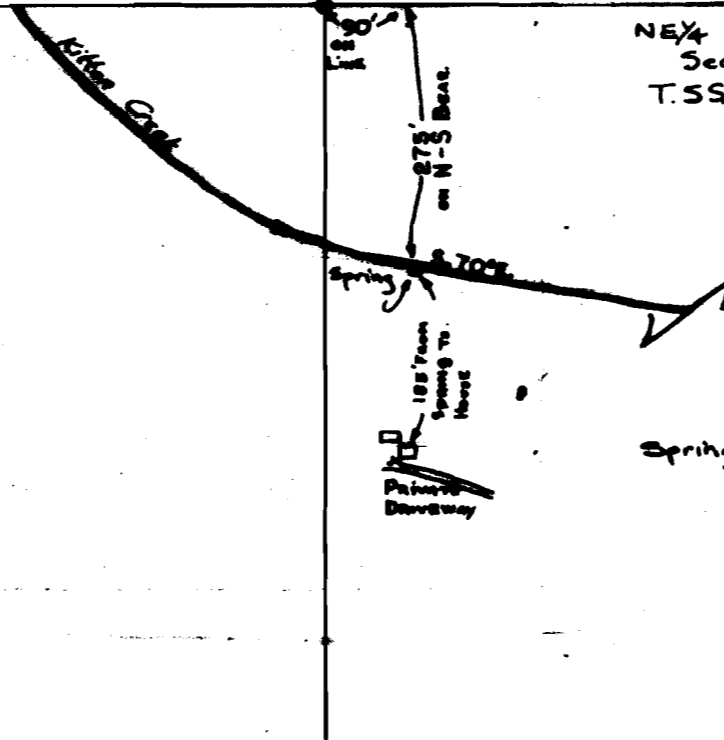

Spring Located East on Section L. Brg. 90' f South
275' on N-S Brg. from section line on Sec. 25, T. 55 R. 9 W.
Fd in the NE 1/4 of the NW 1/4 of Sec. 25.

Scaled From 1974 U-2 Flight Photos.



WATER RIGHTS MAP FOR

Mr & Mrs Charles L. Swenson
Star Rt 1, Hwy. 22
Box 68, Grand Ronde, Oregon
97347

RECEIVED

AUG 19 1975

WATER RESOURCES DEPT.
SALEM, OREGON

RECEIVED

NOV 0 1975

WATER RESOURCES DEPT.
SALEM, OREGON

Application No. 58104
Permit No. 40012

Drawn By: David L. Clark, Aug. 16, 1975