

— MAP —

Accompanying application of ARTHUR B. MYERS, B. F. MORGAN, J. H. M. McKEE and CARLTON Bro's of Roque River, Jackson County Oregon. for permit to the waters of Evans Creek tributary to Roque River, Jackson County, Oregon.

— Medford, Oregon. —
— February, 1919. —

Tp 35. S. R. 4. W. W. M.

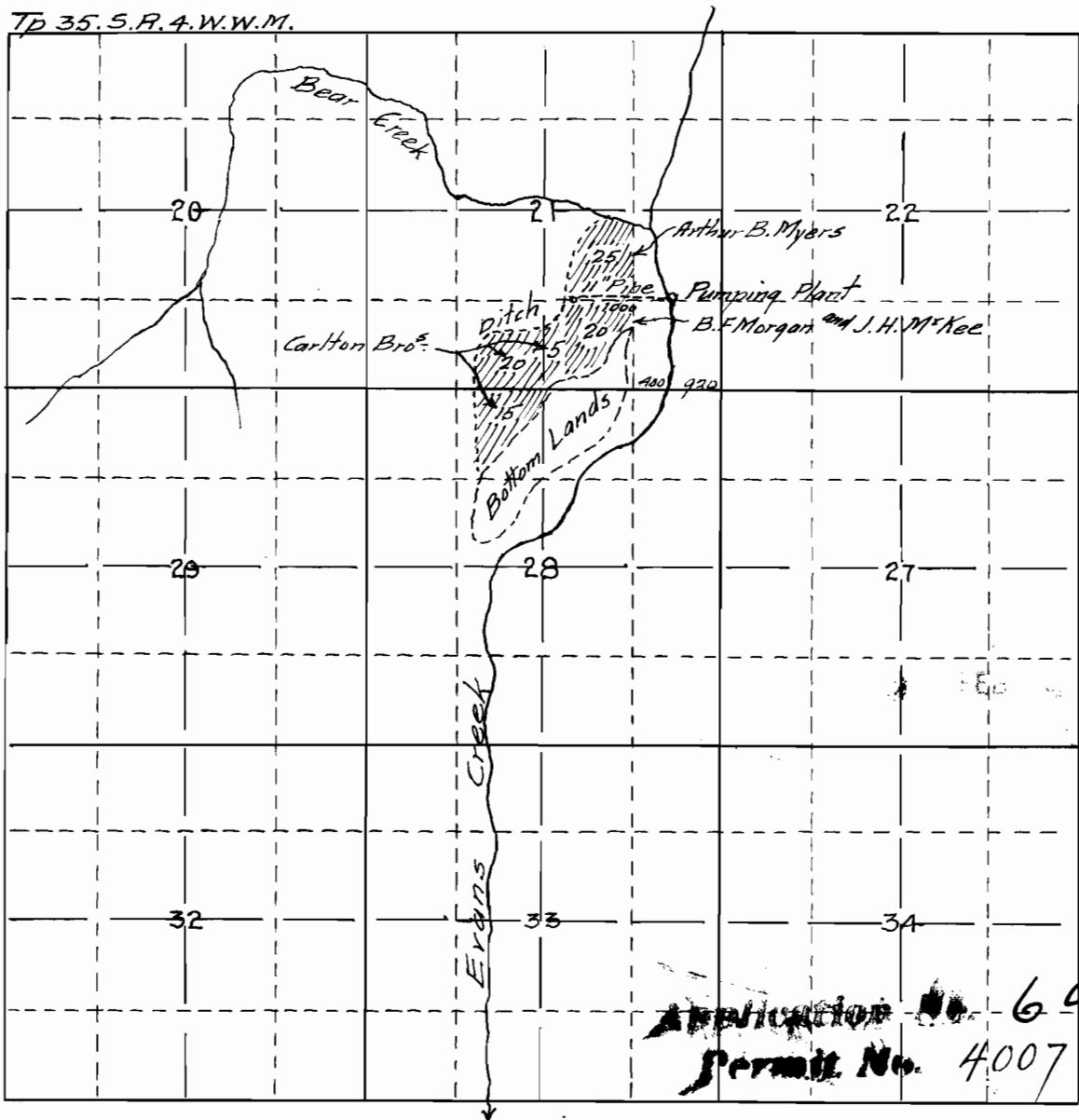

Map compiled from surveyed plat of the Carlton Bro's Lands. and an investigation of Lands by myself. The same being a correct representation of the lands to be irrigated. location of Pumping plant, together with streams and ditches in immediate vicinity

— Fred. N. Cummings, C.E. —