

MALHEUR COUNTY, OREGON.

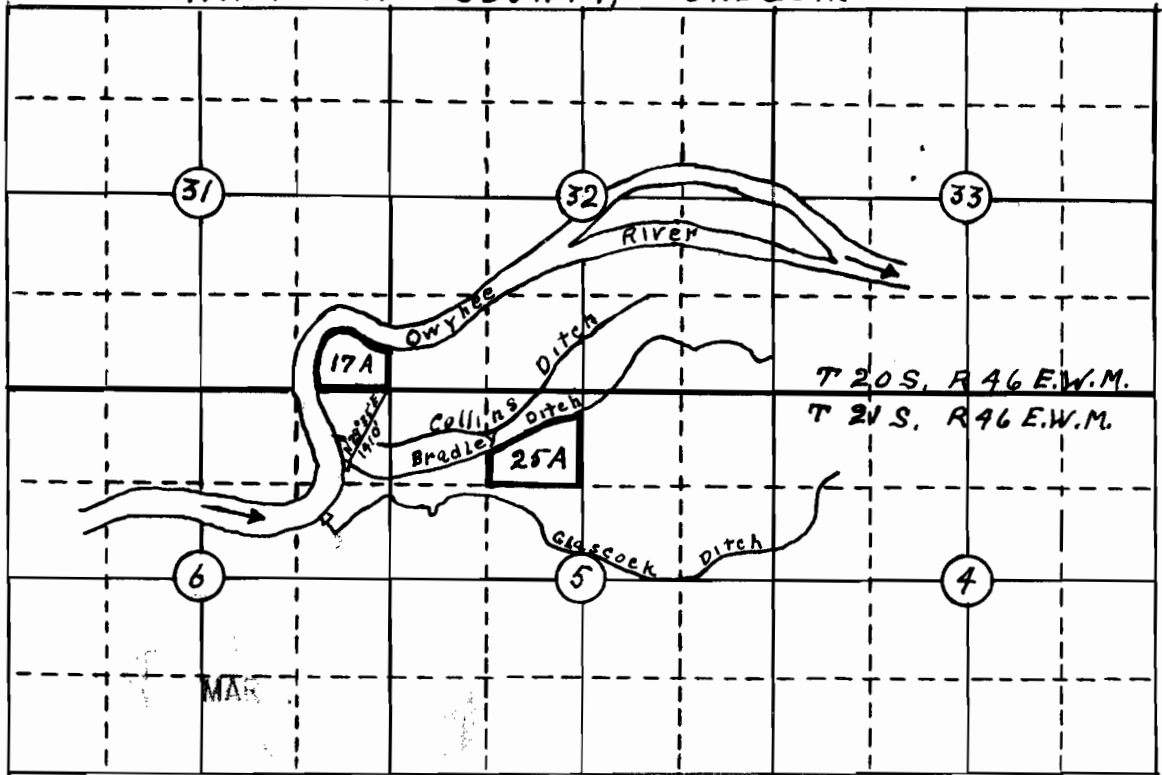

CERTIFICATE of SURVEYOR

I, H.R. OTIS of Nyssa, Malheur County, Oregon do hereby certify that this map was made from notes taken during an actual survey made by me on March 8, 1919 and that it correctly represents the works described in the accompanying application together with the location of streams and other ditches in the immediate vicinity.

H.R. Otis
surveyor.

Application No. 6432
Permit No. 4020

