

Township 1--S.

Range 13 E.W.M.

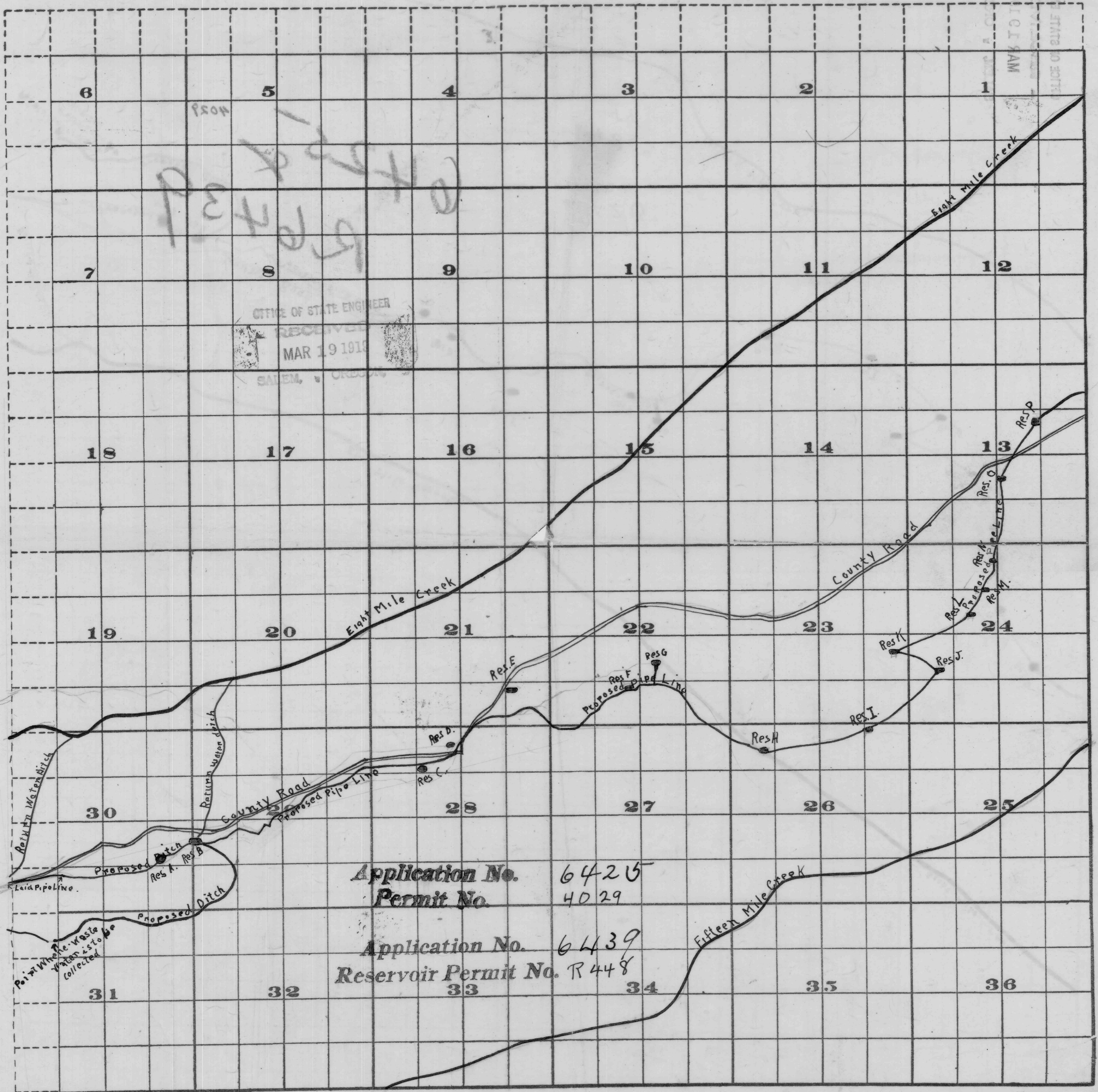

Township 1-S,

Range 14E.W.M.

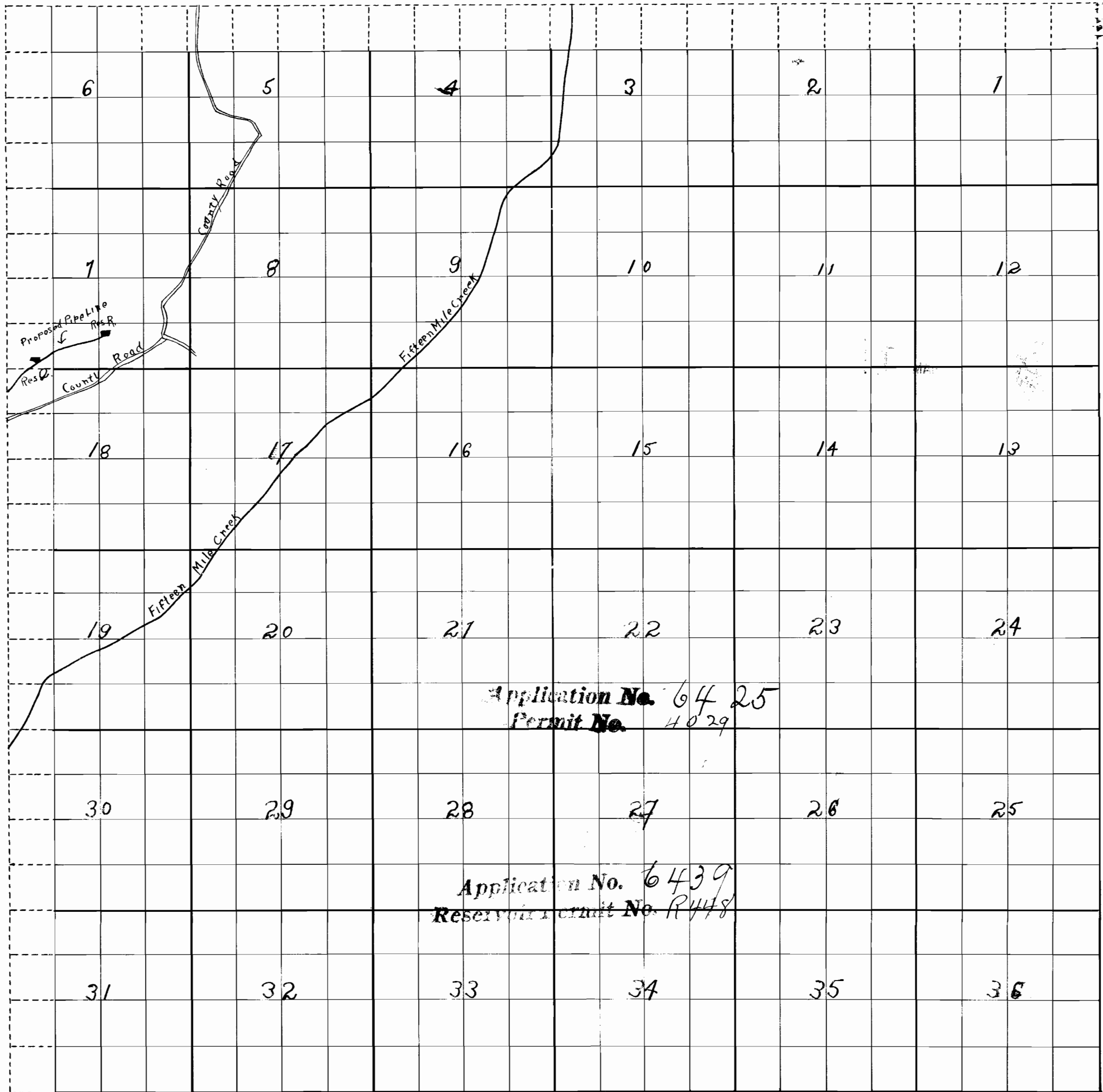

"We started right, and we are right."

DUFUR ORCHARD COMPANY'S SUBDIVISION

7000 Acres. 4000 Acres Planted

ON January 1st, 1916, the purchasers of these tracts organized and incorporated "The Dufur Orchard Co-Owners Company" for the purpose of co-operation in the upkeep of property and the harvesting and marketing of crops. The whole 4000 acres will be conducted as one, with a pro-rata, based on acreage, in maintainance and income.

NO OTHER COMMUNITY of interests in ORCHARDING was ever brought together in such complete organization, which will give the MAXIMUM of returns and MINIMUM of expense.

The confidence of these hundreds of owners in the executives of the Dufur Orchard Company, who originally interested them and who have had their investment in charge, has been shown by their election as executives of the Co-Owners Company.

Dufur Orchard Company

A. C. CHURCHILL, President and General Manager
DONALD CAMPBELL, Secretary

Main Office, The Dalles, Oregon

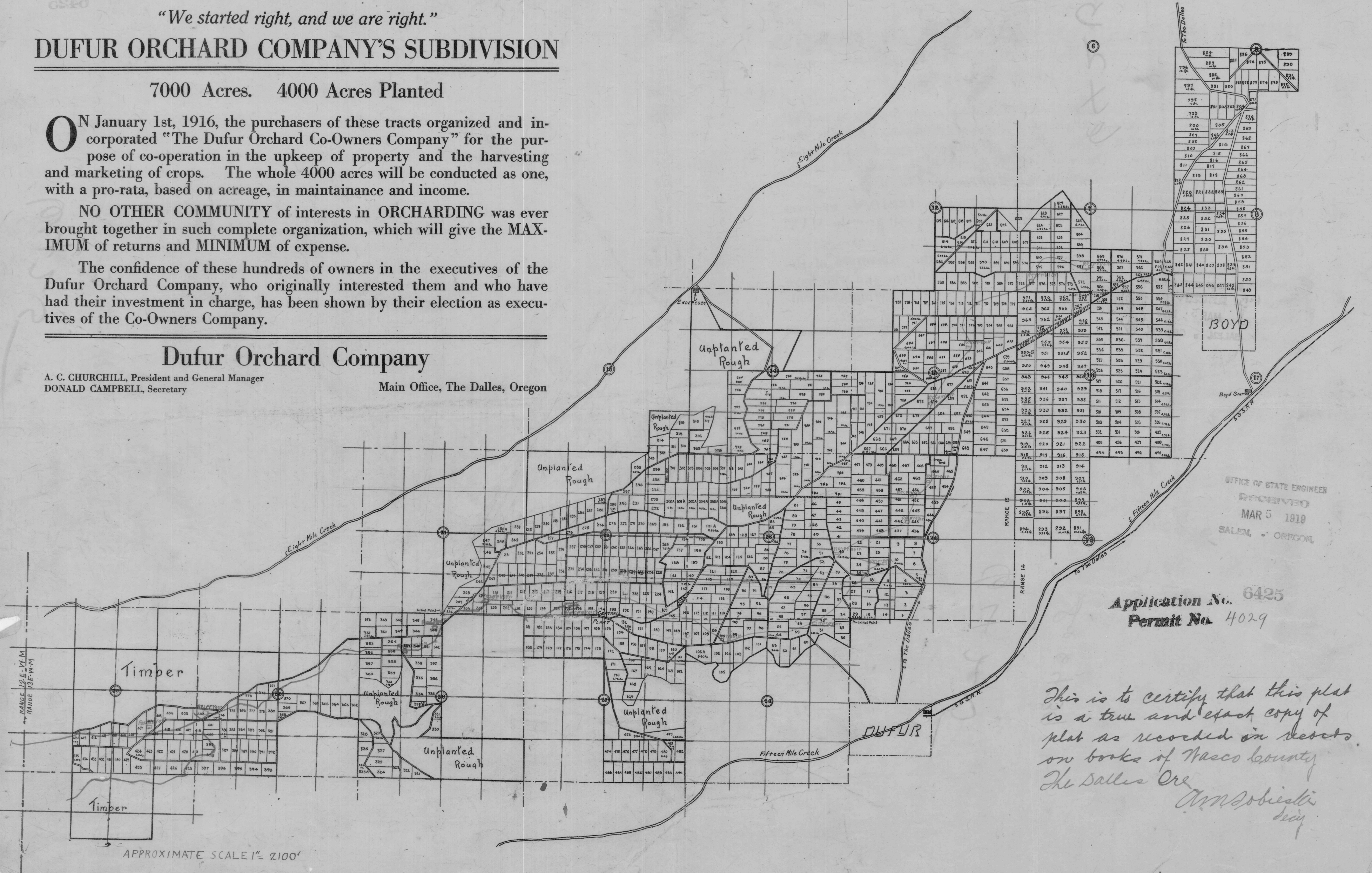

OFFICE OF STATE ENGINEER
RECEIVED
MAR 5 1918
SALEM, OREGON.

Application No. 6425
Permit No. 4029

This is to certify that this plat is a true and exact copy of plat as recorded in records on books of Wasco County The Dalles Ore
Am Sobieski Secy

APPROXIMATE SCALE 1" = 200'