

# COLUMBIA RIVER

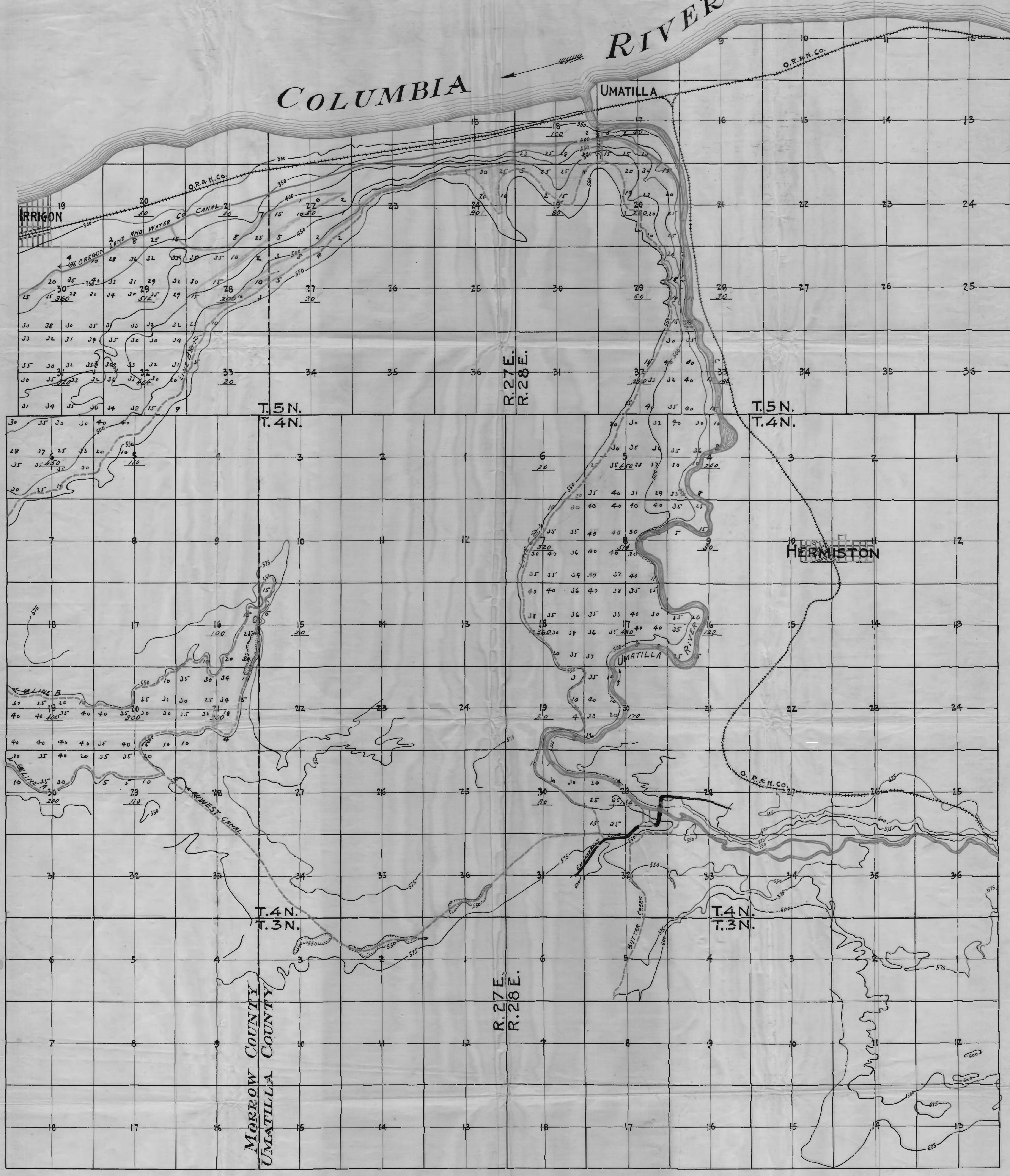

**IRRIGABLE ACREAGE IN:**

- T4N R27E = 1990 ACRES
- T5N R27E = 2326 ..
- T4N R28E = 2998 ..
- T5N R28E = 380 ..
- TOTAL = 8234**

**CERTIFICATE OF SURVEYOR**

State of Oregon,  
County of Multnomah, s.s.  
I, E.G. Hopson, of Portland, Ore, hereby certify that this map was made from notes taken during actual surveys made under my immediate supervision during 1908, 1907, 1908 and 1909, and that it correctly represents the works described in the accompanying application, together with the location of streams and other ditches in the immediate vicinity.

*E.G. Hopson*  
Supervising Engineer, U.S. Reclamation Service

Subscribed and sworn to before me this 14th day of September, 1909.

*Shirley Beck*  
Notary Public for Oregon.

**LEGEND-**

TOTAL IRRIGABLE ACREAGE IN EACH SECTION SHOWN THUS- 123

IRRIGABLE LANDS SHOWN THUS-

Small figures in corners of 1/4 sections indicate irrigable areas in corresponding 40 acre tracts.

DEPARTMENT OF THE INTERIOR

UNITED STATES RECLAMATION SERVICE  
EXTENSION OF  
WEST UMATILLA PROJECT - OREGON

IRRIGABLE ACREAGES IN T.4 N. RS. 27<sup>th</sup> & 28 E.  
AND T.5 N. RS. 27<sup>th</sup> & 28 E.

HERMISTON, OREGON.

SCALE 2 IN = 1 MILE  
SHEET #1

SEPTEMBER, 1909.

Application Permit No. 408



# COLUMBIA RIVER

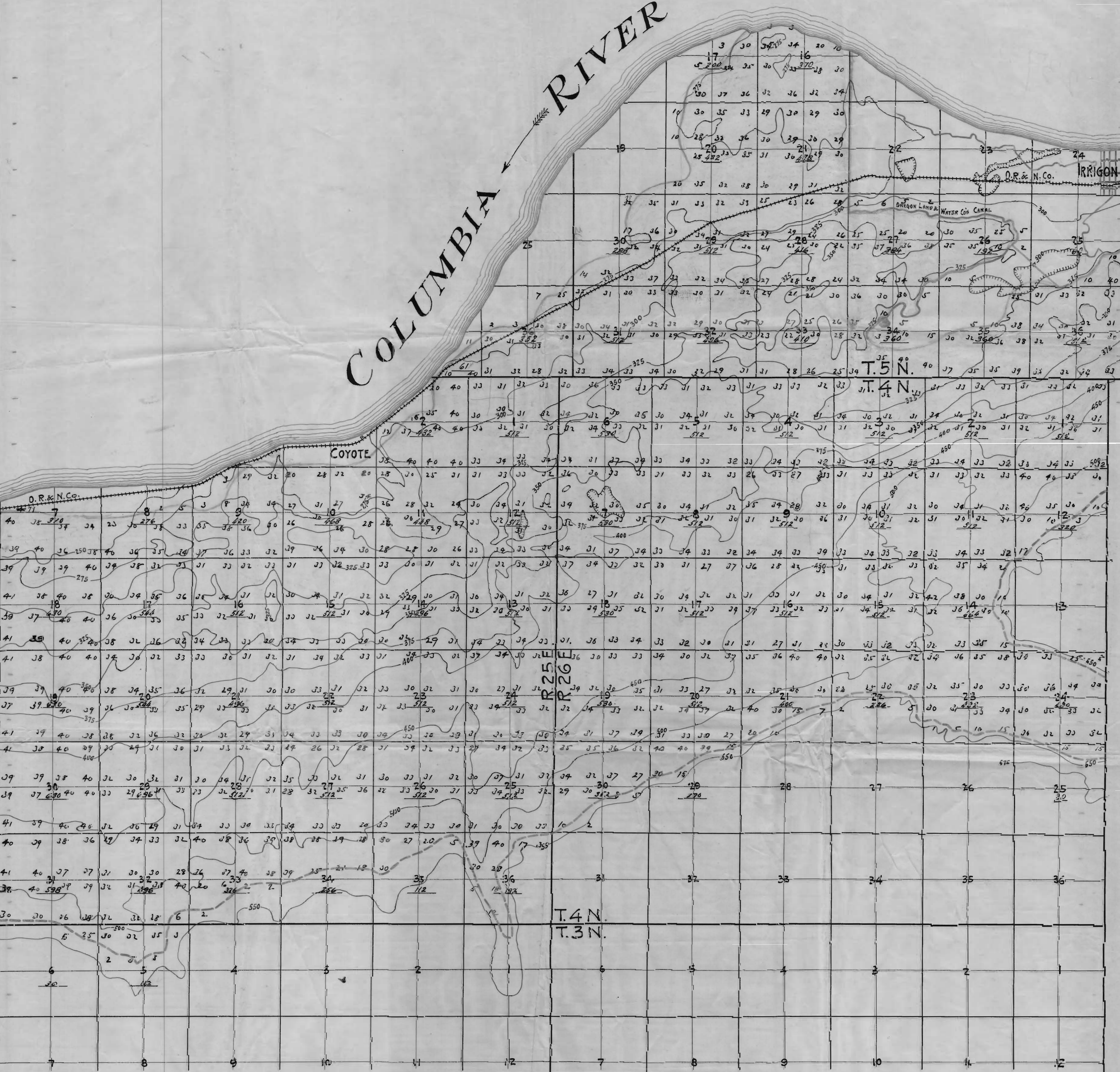

IRRIGABLE ACREAGES IN:

T3NR25E =	142 ACRES
T4NR25E =	14954 "
T5NR25E =	413 "
T4NR26E =	11,680 "
T5NR26E =	5,982 "
TOTAL =	33,171 "

DEPARTMENT OF THE INTERIOR  
 UNITED STATES RECLAMATION SERVICE  
 EXTENSION OF  
 WEST UMATILLA PROJECT - OREGON  
 IRRIGABLE ACREAGES IN T.3 N. R. 25 AND 26 E.,  
 T.4 N. R. 25 AND 26 E., AND T.5 N. R. 25 AND 26 E.  
 Application No. 237  
 Permit No. 408  
 HARMISTON, OREGON. SCALE 2 IN = 1 MILE  
 SHEET #2  
 SEPTEMBER, 1909.

LEGEND—  
 TOTAL IRRIGABLE ACREAGE IN EACH SECTION SHOWN THUS—322.  
 IRRIGABLE LANDS SHOWN THUS—  
 Small figures in corners of the sections indicate irrigable areas in corresponding 32 acre tracks.

CERTIFICATE OF SURVEYOR  
 State of Oregon  
 County of Multnomah, S.S.  
 I, E. G. Hopson of Portland, Ore., hereby certify that this map was made from notes taken during actual surveys made under my immediate supervision during 1906, 1907, 1908, and 1909 and that it correctly represents the works described in the accompanying application, together with the location of streams and other ditches in the immediate vicinity.  
 E. G. Hopson  
 Supervising Engineer, U.S. Reclamation Service

Subscribed and sworn to before me this 10th day of September 1909

Shirley Rust  
 Notary Public

Map to accompany application No. 237



CERTIFICATE OF SURVEYOR  
 State of Oregon )  
 County of Multnomah ) s.s.  
 I, E. G. Hopson, of Portland, Ore., hereby certify that this map was made from notes taken during actual surveys made under my immediate supervision during 1906, 1907, 1908, and 1909 and that it correctly represents the works described in the accompanying application, together with the location of streams and other ditches in the immediate vicinity.  
 E. G. Hopson  
 Supervising Engineer U.S. Reclamation Service  
 Subscribed and sworn to before me this 16th day of September 1909.  
 Shirley Bush  
 Notary Public

DEPARTMENT OF THE INTERIOR  
 UNITED STATES RECLAMATION SERVICE  
 EXTENSION OF  
 WEST UMATILLA PROJECT - OREGON

IRRIGABLE ACREAGES IN T.3N.Rs.22,23 AND 24E.  
 AND T.4N.Rs.22,23 AND 24E.

HERMISTON, OREGON. SCALE 2 IN=1 MILE  
 SHEET #3 SEPTEMBER, 1909.

TOTAL IRRIGABLE ACREAGE IN:  
 T4N R22E = 365 Acres  
 T3N R23E = 644 ..  
 T4N R23E = 6836 ..  
 T3N R24E = 1056 ..  
 T4N R24E = 9484 ..  
 TOTAL = 18385 ..

LEGEND-  
 TOTAL IRRIGABLE ACREAGE IN EACH SECTION SHOWN THUS: 123.  
 IRRIGABLE LAND SHOWN THUS: [Symbol]  
 Small figures in corners of 1/4 sections indicate irrigable areas in corresponding 40 acre tracts.

Application No. 237  
 Permit No. 7408

