

SE 1/4 SEC. 20 T. 17 S. R. 12 E. W.M.

dead number 201

17-12-20

DESCHUTES COUNTY

SCALE: 1" = 400'

1712201

See Map 17 12 20A

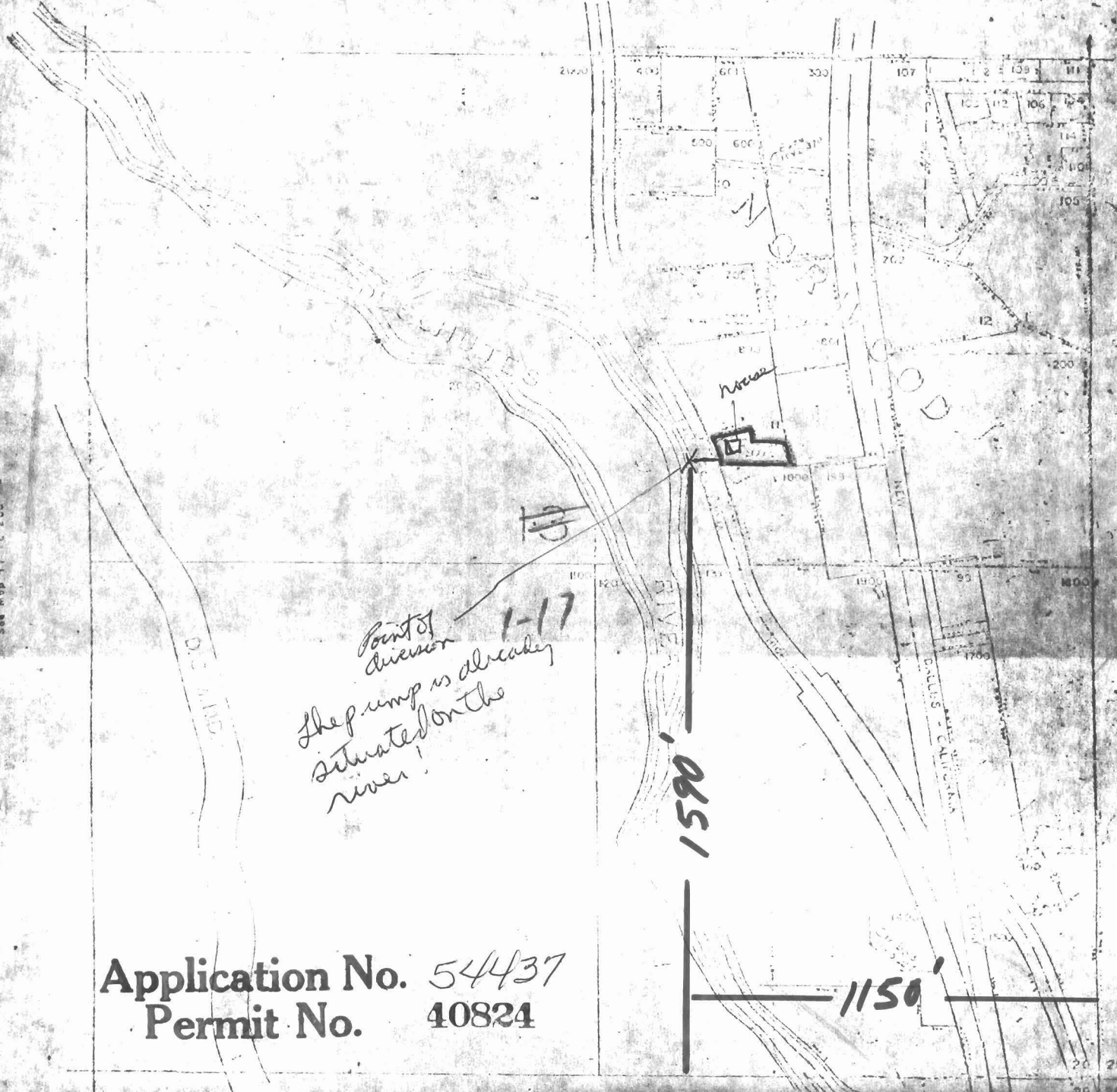

*Point of  
diversion 1-17  
The pump is already  
situated on the  
river*

**Application No.** 54437  
**Permit No.** 40824

**RECEIVED**

SEP 13 1976

WATER RESOURCES DEPT  
SALEM, OREGON

See Map 17 12 20A

17 12 20