

T.37S.,R.6W.,W.M.

RECEIVED
AUG 7 1979
WM. DIST. 14
GRANTS PASS, ORE.

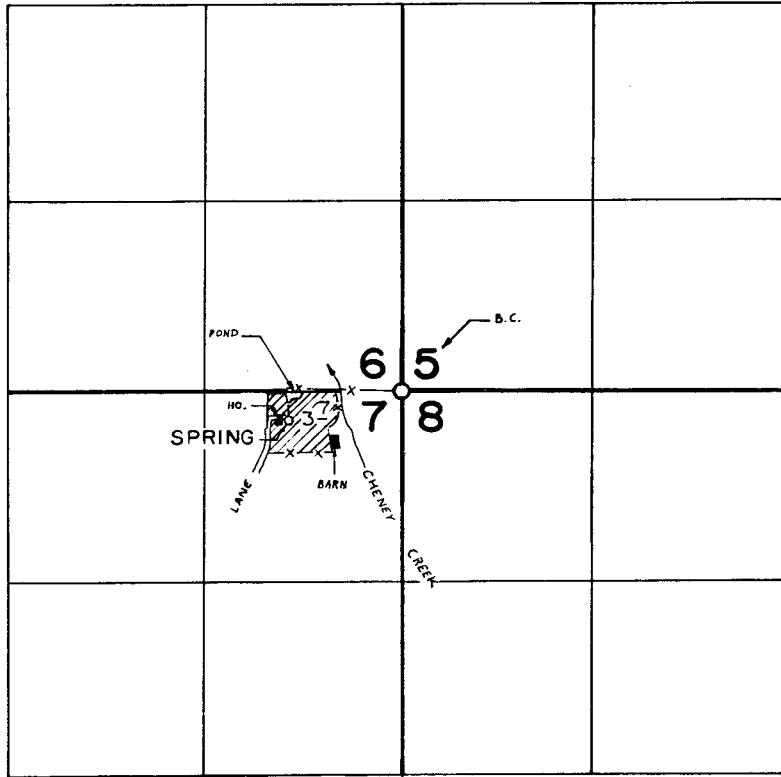

SPRING LOC.: 200' S. & 770' W. FROM N.E. COR. SEC. 7

FINAL PROOF SURVEY
UNDER

Application No. 54606 Permit No. 40975
IN NAME OF

HAROLD & BOBBY ERDRICH

Surveyed OCT. 13, 1977, by B. SUND