

25 30
36

30 29
32

RECEIVED
OCT 5 1976
LAND RESOURCES DEPT.
OREGON

Application No. 54850
Permit No. 41146
43

A.D.M. DORITY
704-754

ANGLE CORNERS
SOUTH LINE
J.F. MARKLEY
LAND CLAIM

N.W. COR.
G. APLIN
DLC No. 64

N.E. COR.
J. MESPLIE
LAND CLAIM

37.84
S 31.9 77.5
S 32.2 82.04

1142
272-058
609-246

N.W. COR.
J.F. MARKLEY
LAND CLAIM

N.E. COR.
J. MESPLIE
LAND CLAIM

30.00

32
5

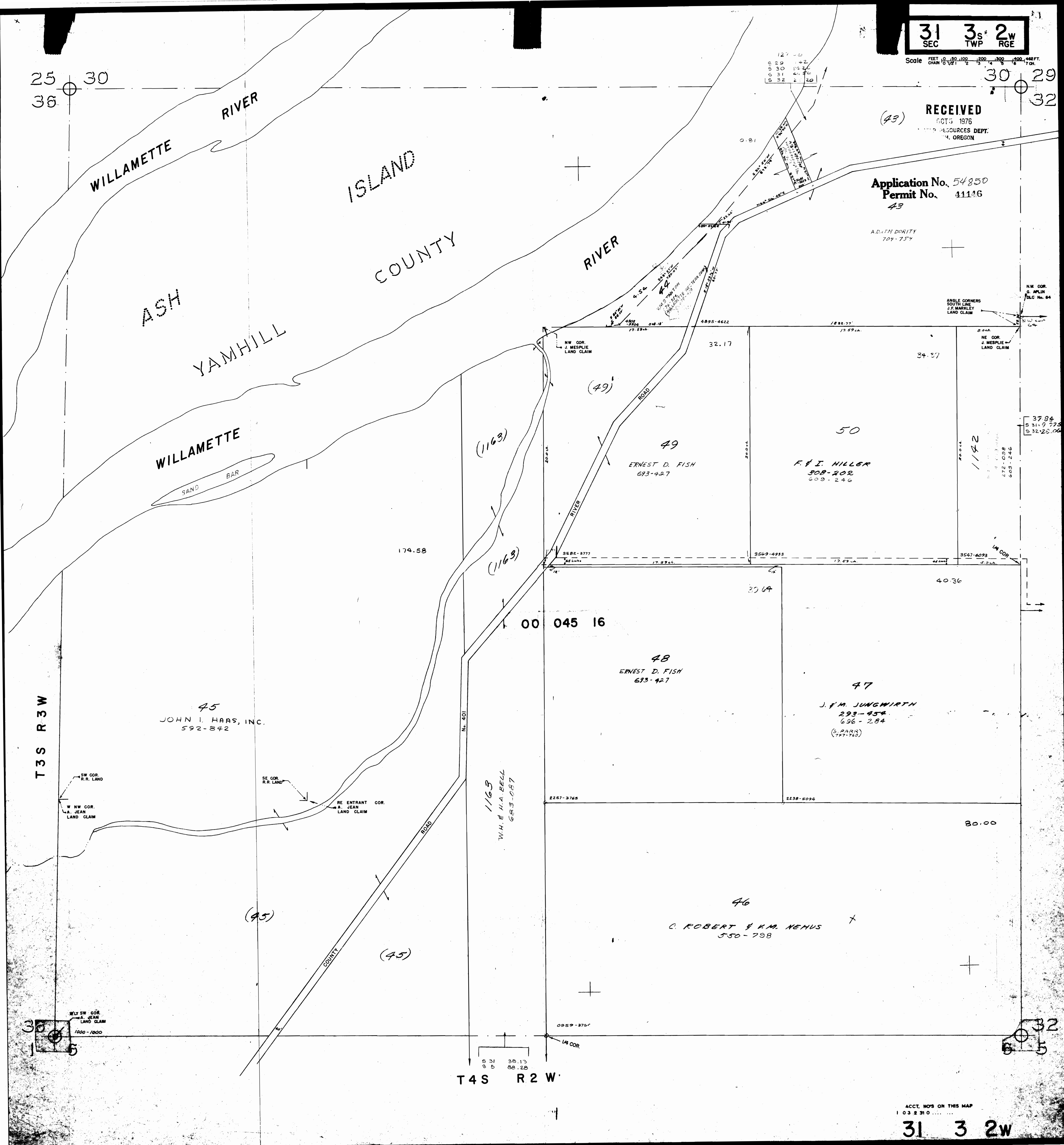

T3S R3W

T4S R2W

45
JOHN I. HAAS, INC.
592-842

48
ERNEST D. FISH
693-427

47
J.F.M. JUNGWIRTH
293-454
696-284
(S. PARR)
747-760

49
ERNEST D. FISH
693-427

50
F. & I. HILLER
308-202
609-246

46
C. ROBERT & K.M. NEHUS
550-798

1163
W.H.E. H.A. BELL
683-087

(1163)

(1163)

(49)

(45)

(45)

174.58

32.17

34.37

30.64

40.36

00 045 16

SW COR.
R.R. LAND

SE COR.
R.R. LAND

RE-ENTRANT COR.
A. JEAN
LAND CLAIM

W NW COR.
A. JEAN
LAND CLAIM

N.E. SW COR.
A. JEAN
LAND CLAIM
1000-1000

3582-3777
17.594

17.594

1882.77

5.044

3547-6093
17.594

17.594

2267-3765

2238-6094

0959-3764
1/4 COR.

31 36.15
35 88.28

Table with 2 columns and 5 rows of numerical data.