

T. 3 S. R. 10 W. W. M.

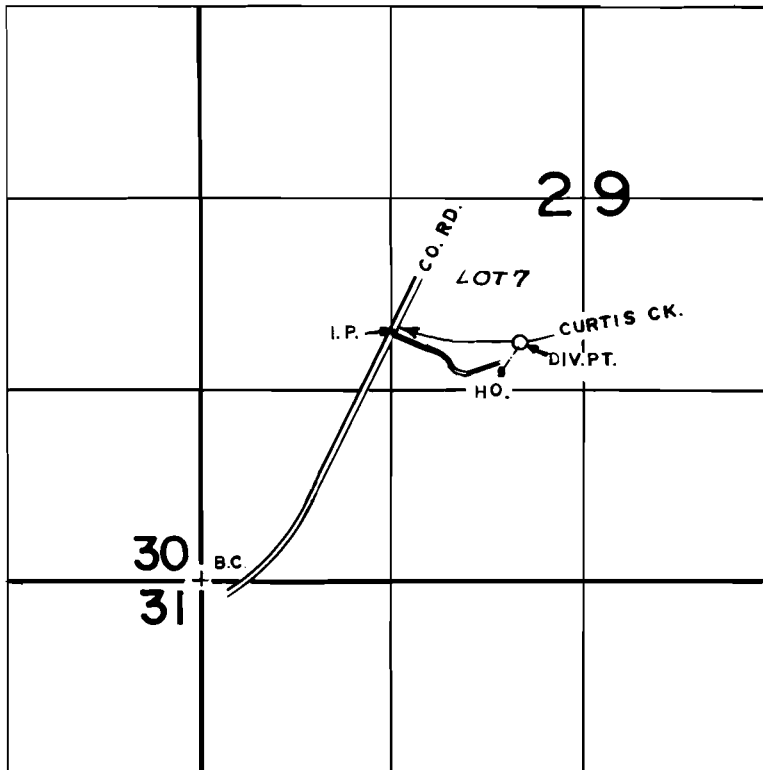

DIV. PT. LOC. 1650' N. & 2200' E. FROM S.W. COR. SEC. 29

FINAL PROOF SURVEY UNDER

Application No. ~~54853~~ Permit No. 41147.....
IN NAME OF

.....AARON L. & HELEN L. STAUFFER.....

Surveyed JAN. 25. 1980, by R.G. MUCKEN.....