

North Umpqua River

P.O.D. 830 feet North
25 feet East from SW Corner of NW $\frac{1}{4}$ SE $\frac{1}{4}$ Sec. 14
West

Application No. 54953
Permit No. 41245

RECEIVED

WATER RESOURCES DEPT.
SALEM, OREGON

RECEIVED

NOV 15 1976
WATER RESOURCES DEPT.
SALEM, OREGON

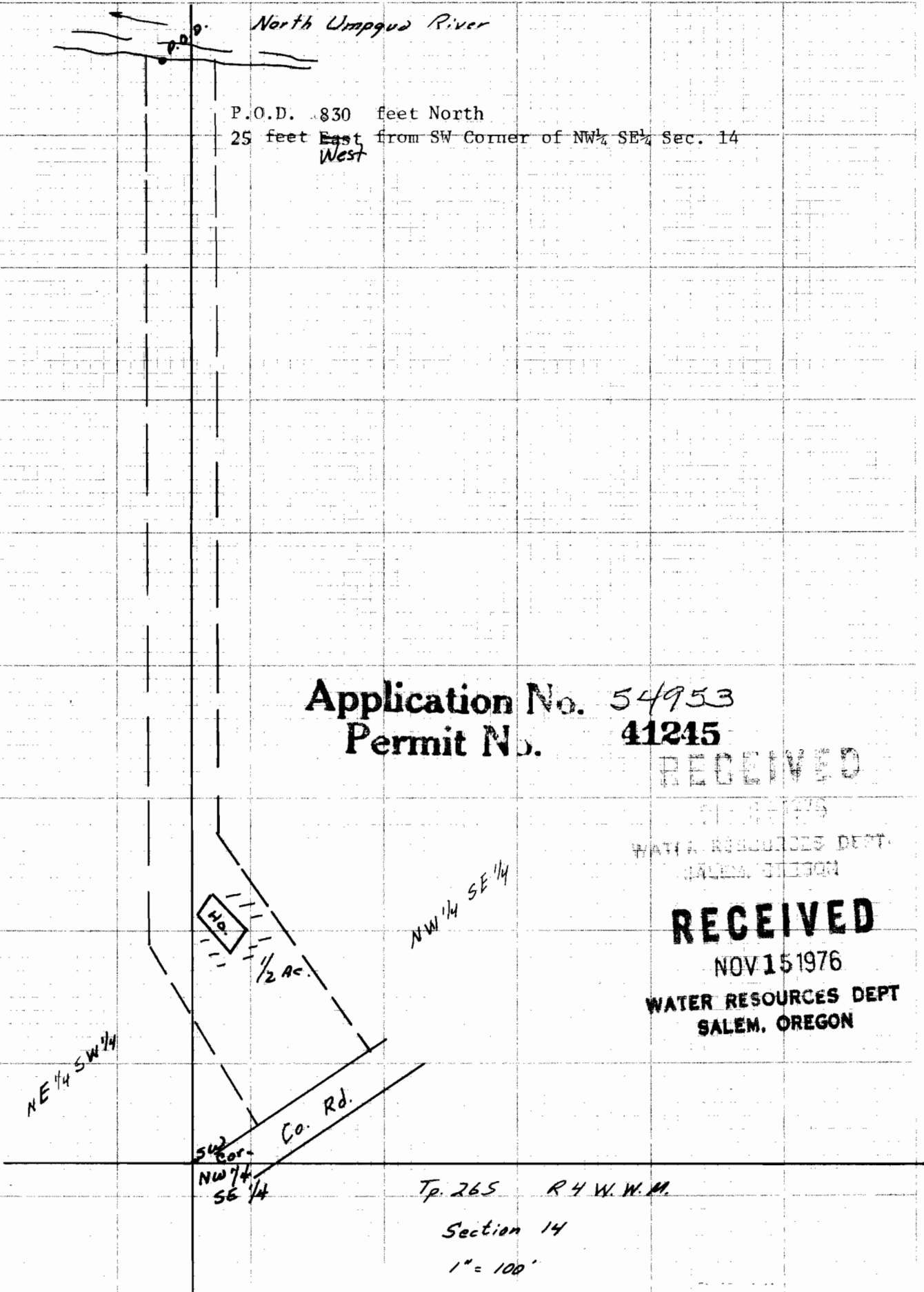

Tp. 26S R. 4 W. W. M.

Section 14

1" = 100'