

T.27S.,R.5W.,W.M.

Section 30

NE 1/4 SW 1/4

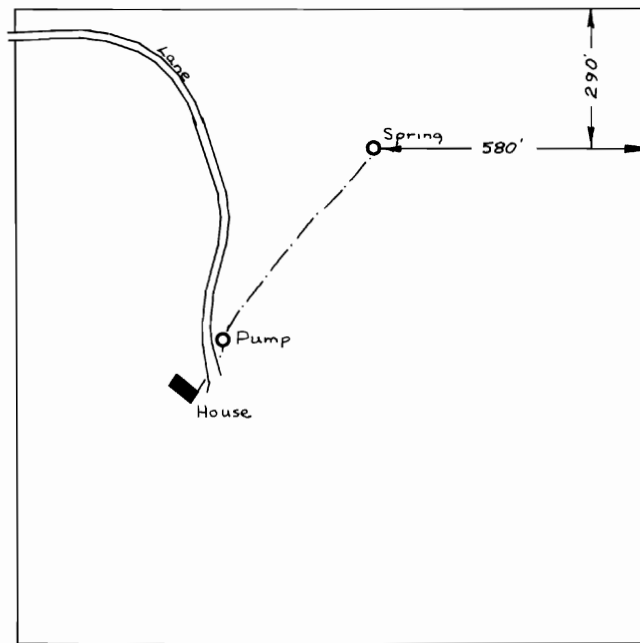

SCALE: 1" = 400'

FINAL PROOF SURVEY
UNDER

Application No. 55170 Permit No. 41349
IN NAME OF

MELVIN & LETTA MENDENHALL

Surveyed March 12, 1980., by J. S. DONALDSON.