

Application No. 55545
 Permit No. 41506

RECEIVED

1977

DEPT.

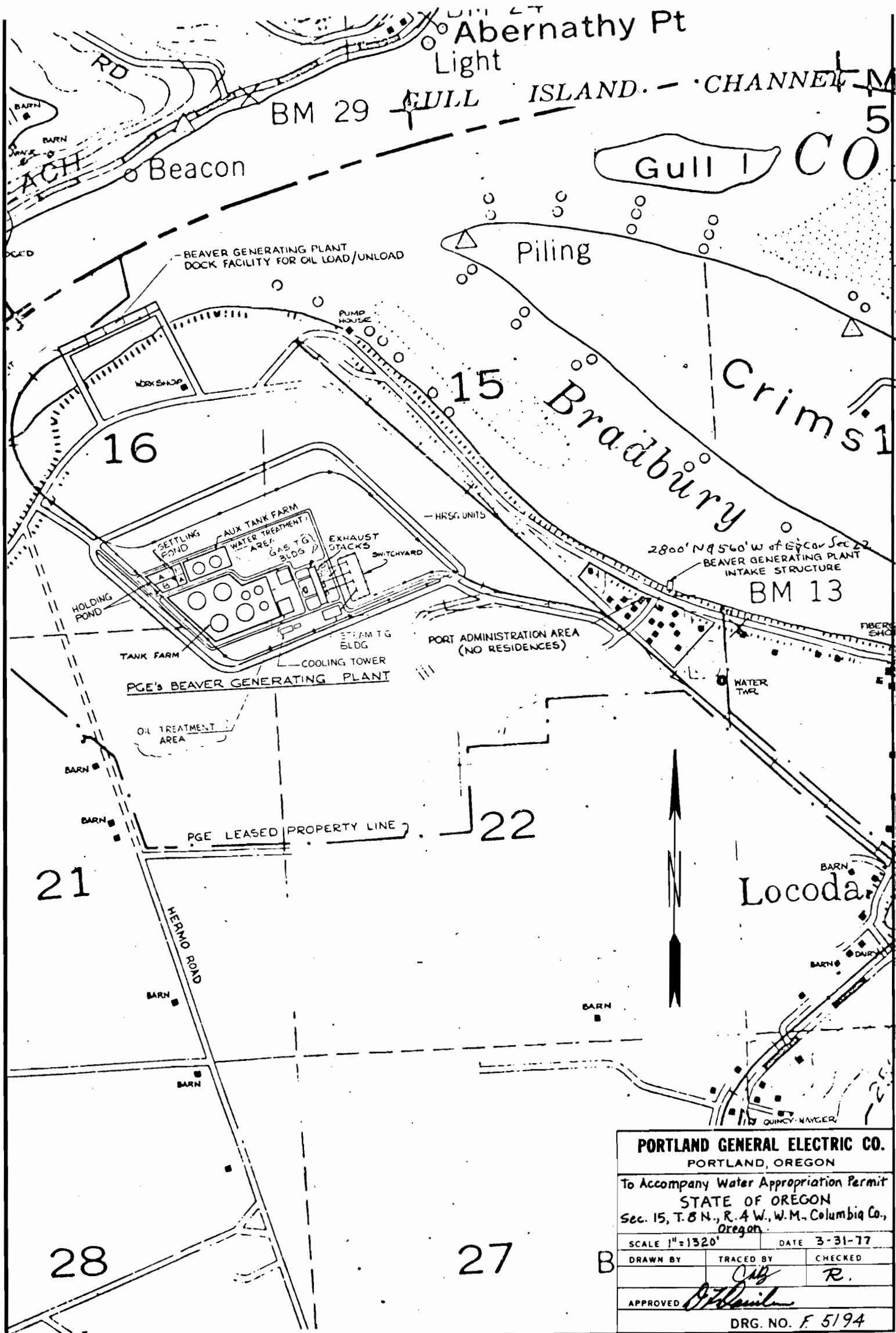

PORTLAND GENERAL ELECTRIC CO.		
PORTLAND, OREGON		
To Accompany Water Appropriation Permit		
STATE OF OREGON		
Sec. 15, T. 8 N., R. 4 W., W.M. Columbia Co., Oregon		
SCALE 1"=1320'	DATE 3-31-77	
DRAWN BY	TRACED BY	CHECKED
	<i>CSB</i>	R.
APPROVED <i>[Signature]</i>		
DRG. NO. F 5194		