

T.37S., R.5 & 6W., W.M.

RECEIVED
 JUL 7 1982
 WM. DIST. 14
 BRANTS PASS, ORE

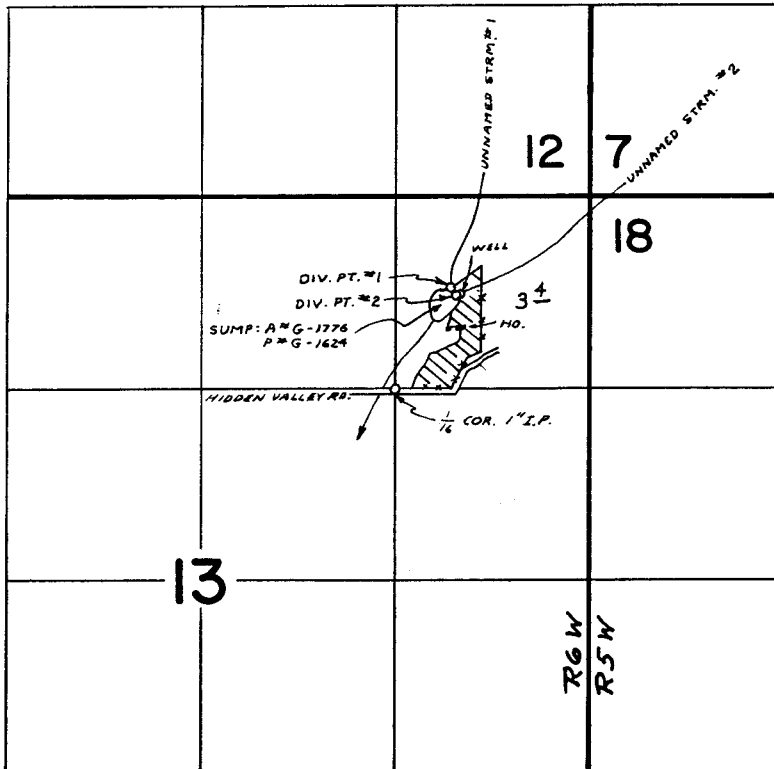

WELL LOC. : 670'S & 870'W FROM NE COR. SEC. 13
 DIV. PT. #1 LOC. : 620'S & 990'W FROM NE COR. SEC. 13
 DIV. PT. #2 LOC. : 680'S & 890'W FROM NE COR. SEC. 13

FINAL PROOF SURVEY
 UNDER

G-7171 G-6610 SUPPL.
 Application No. 55596 Permit No. 41662 SUPPL.

IN NAME OF
 ROBERT J. & PATRICIA S. LEIENDECKER

Surveyed OCT. 14 1977 by B. SUND

P.T.S.-1977-14-B