

T. 26 S., R. 4W, NW $\frac{1}{4}$ Sec. 15

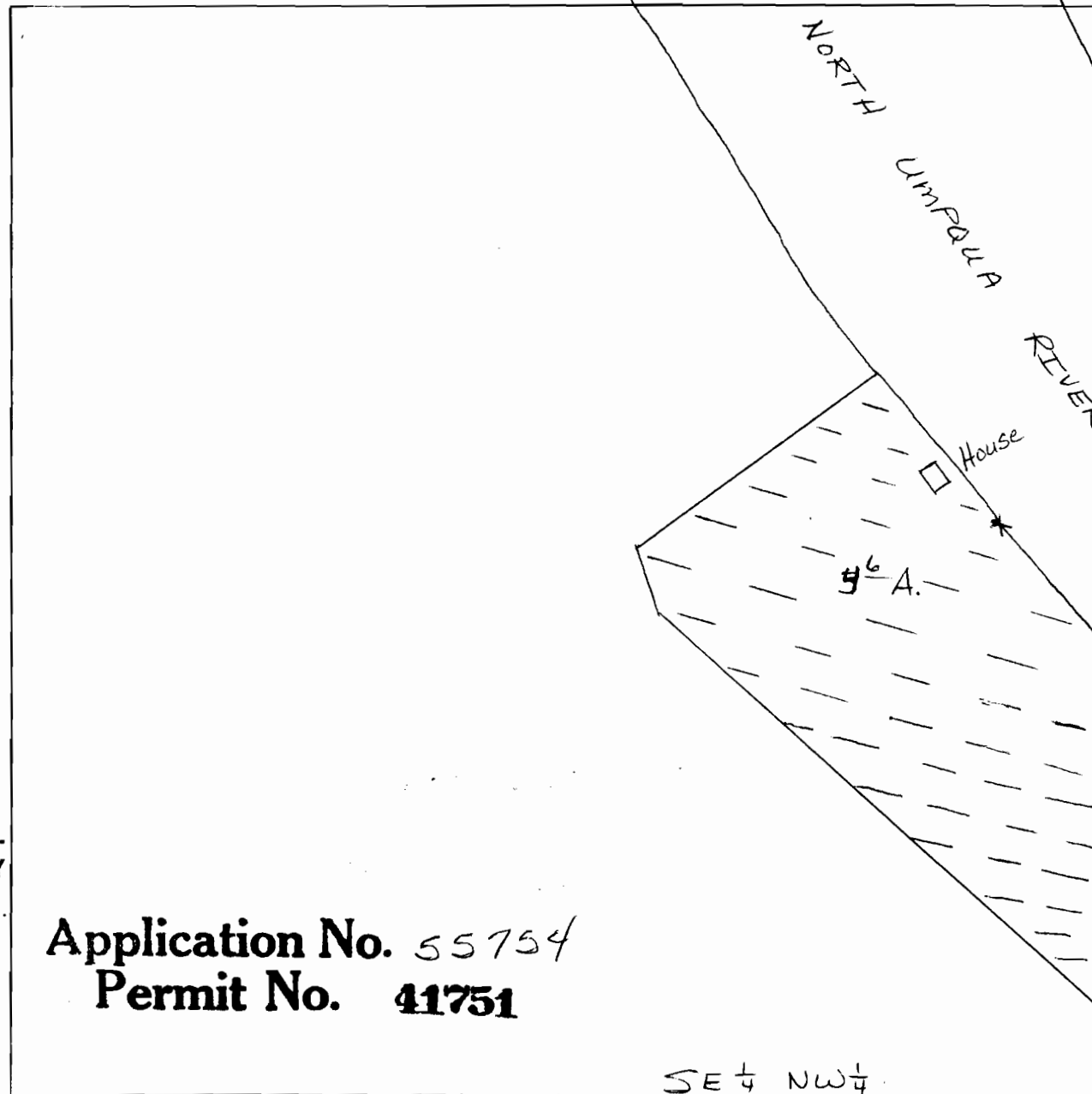

1" = 200'



700' N.

120' W

THIS MAP PREPARED BY:

Gail M. Hays

FROM INFORMATION FURNISHED BY
THE APPLICANT.

Application No. 55754
Permit No. 41751

SE $\frac{1}{4}$ NW $\frac{1}{4}$

CENTER OF
SEC. 15