

# T. 38 S., R. 7 W., W.M.

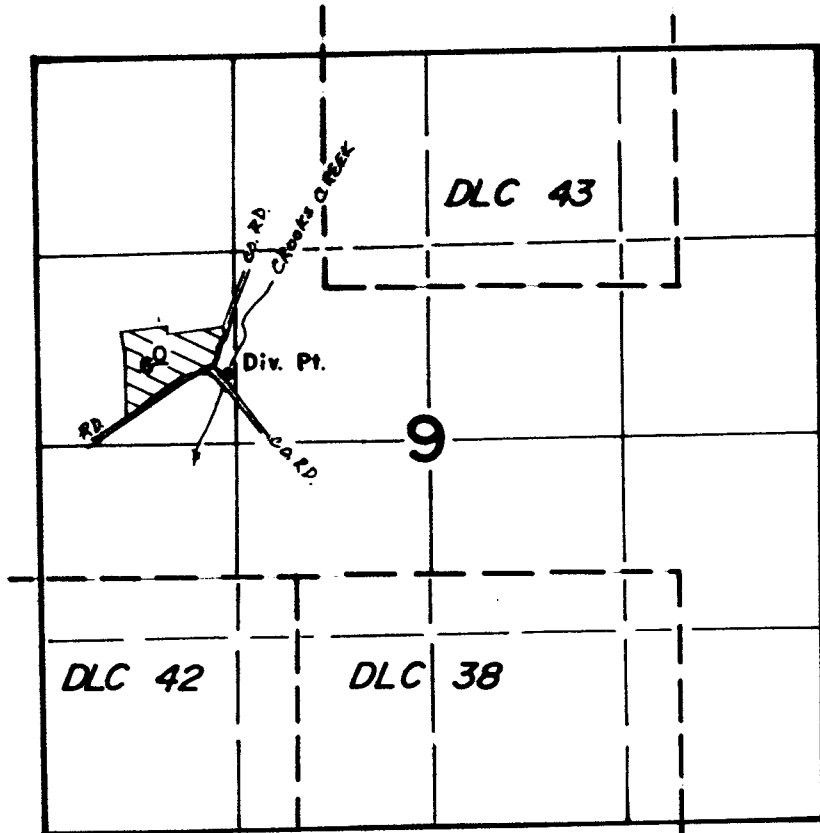

DIV. PT. IS LOCATED 470' N. AND 1290' E. FROM THE W 1/4 CORNER OF SECTION 9.

## FINAL PROOF SURVEY UNDER

Application No. 55547... Permit No. 41857.....  
IN NAME OF

**ERNEST B. & ALMA W. SORENSON**

Surveyed OCT. 27, 1983, by B. S. JAMES.....

RECORDED

MAR 08 1989

RECORDED  
GENERAL RECORDS

179-173 L me 1984