

T. 37 S., R. 7 & 8 W., W. M.

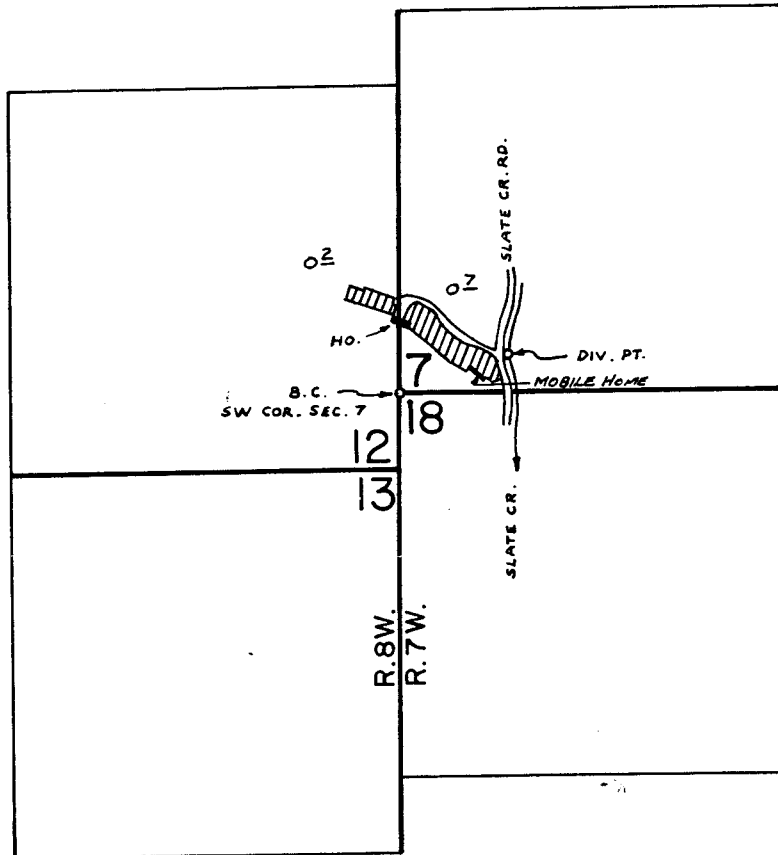

DIV. PT. LOC. : 130' N. $\frac{1}{2}$ 370' E. FROM SW COR. SEC. 7

SCALE: 1" = 660 FT.

FINAL PROOF SURVEY
UNDER

Application No. 56548 Permit No. 42427
IN NAME OF

Arno R. & Brigitte Hindemit

Surveyed NOV. 1 1978 by B. SUND

RECEIVED

MAY 18 1982

WM. DIST. 14
GRANTS PASS, ORE

P.T.S. - 1978 - 14 - D