

T.36S., R.6W., W.M.

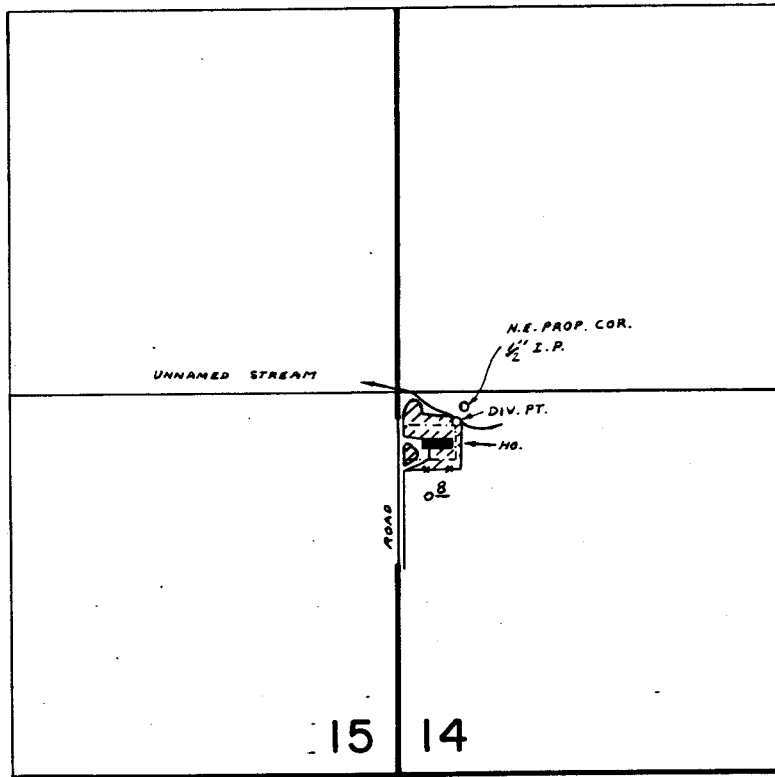

DIV. PT. LOC. : 1220' N. & 200' E. FROM SW COR. SEC. 14

SCALE : 1" = 660 FT.

FINAL PROOF SURVEY
UNDER

RECEIVED
OCT 1 1981
WM. DIST. 14
GRANTS PASS. ORE.

Application No. 56487 Permit No. 42437 SUPPL.
IN NAME OF

IRVIN R. & ELLA ROSE SOWERS

Surveyed JUN. 23 1978 by B. SUND

P.T.S. - 1978 - 14 - A