

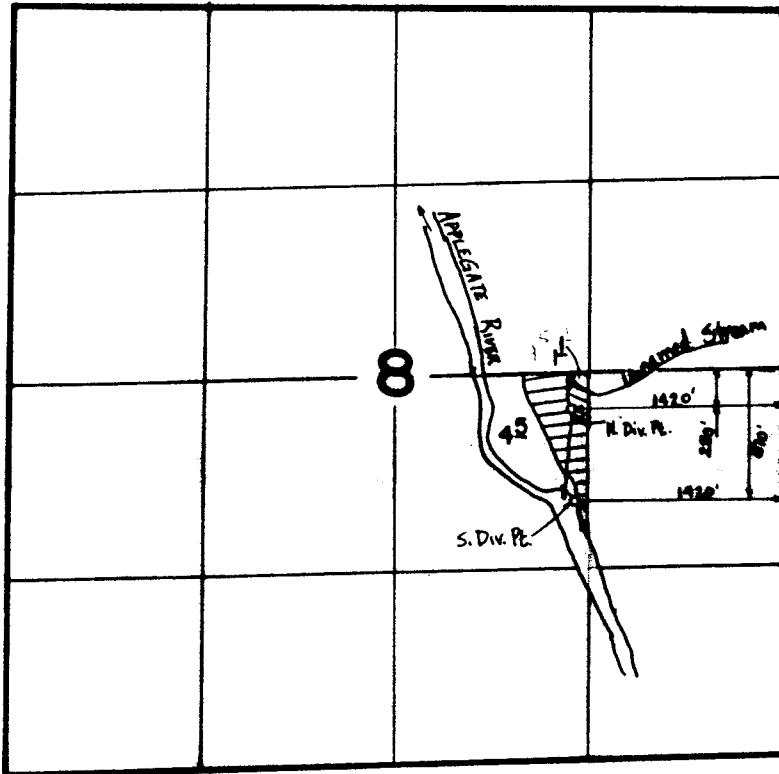

# T.37S., R.6 W., W.M.



1420'  
1420'  
42'  
42'  
MAY 23 1989  
STATE OF MONTANA  
COUNTY OF ...

-  Primary from South Diversion Point
-  Primary from North Diversion Point,  
Supplemental from South Div. Pt.

## FINAL PROOF SURVEY UNDER

Application No. 56471.. Permit No. 42439....  
IN NAME OF

.....**ROBERT P. STRAHAN**.....

Surveyed OCT. 18, 1983., by B.S. JAMES.....