

26 25
35 36

See Map 25 29 15

W E

Scale 1"=200'

This print is made solely for the purpose of assisting in locating said premises and the company assumes no liability for variations, if any, in dimensions and location ascertained by actual survey.

ORDER NO.

WILLAMETTE VALLEY TITLE CO.

294 CENTRAL COOS BAY, OREGON
PHONE 269-0119

8.2700

12439-1

Application No. 56653
Permit No. 42456

LOST LAKE

LOST LAKE

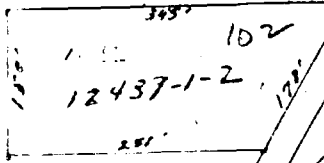
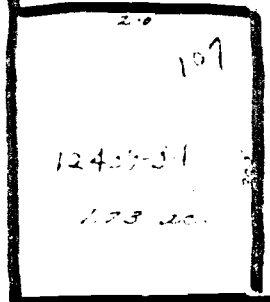

12440

12439-4
2 ac

COUNTY ROAD

12439-5
2.5 ac

Shaded area irrigated lawn & garden one-half acre.

12440

12459-2

12459-2

NW 1/4 of the NW 1/4 of Sec 36 TP 29 S R 15W WMT In County of Coos, OR.

See Map 35A 29 15