

T5S, R5W, W.M.  
 Yamhill County  
 Transfer Map - Certificate 50648  
 Christensen Farms LLC

RECEIVED

SEP 27 2012

WATER RESOURCES DEPT  
 SALEM, OREGON

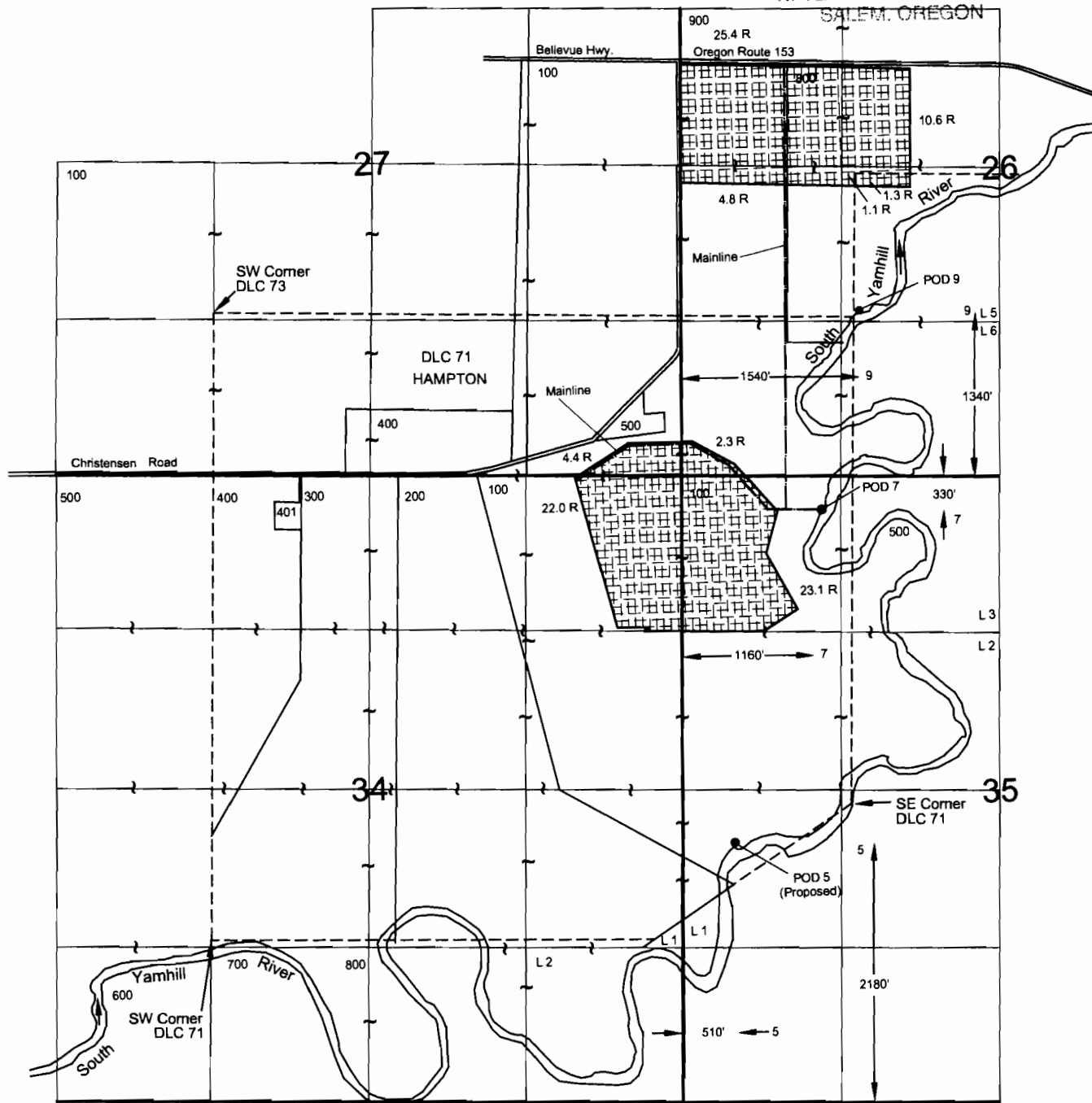

August 20, 2012

THIS MAP IS NOT INTENDED TO  
 PROVIDE LEGAL DIMENSIONS OR  
 LOCATIONS OF PROPERTY  
 OWNERSHIP LINES.

**SKOOKUM**

WATER ASSOCIATES INC  
 P.O. Box 80174  
 Portland, OR 97280  
 (503) 319-8926

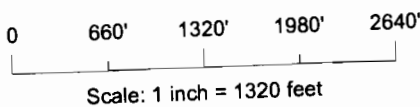
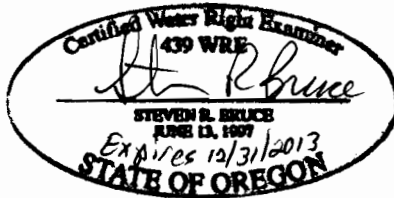

Explanation:



Remaining Rights - 95.0 A  
 (R)

Priority Date: May 4, 1977

Figure 8