

Permit: S 42950  
Volume: 6B  
Strm: WILLIAMS CR  
Trib: APPLGATE R  
Priority: 2/17/78

Application No. 57088  
Permit No. 42950

TOWNSHIP 38 SOUTH  
RANGE 5 W., W. M. SECTIONS 12 & 13  
JOSEPHINE COUNTY  
SCALE: 1" = 400'



DIVERSION POINT:  
135' South and 135' East  
from SW corner Section 12  
being within NW $\frac{1}{4}$ NW $\frac{1}{4}$  Section 13  
(Spencer Ditch)

Survey by inspection according to Tom Shook, which means this is the only map we will get because the surveyor found the use to be exactly as the original application stated.

RECEIVED  
MAY 30 1978  
WM. DIST. 14  
GRANTS PASS, ORE

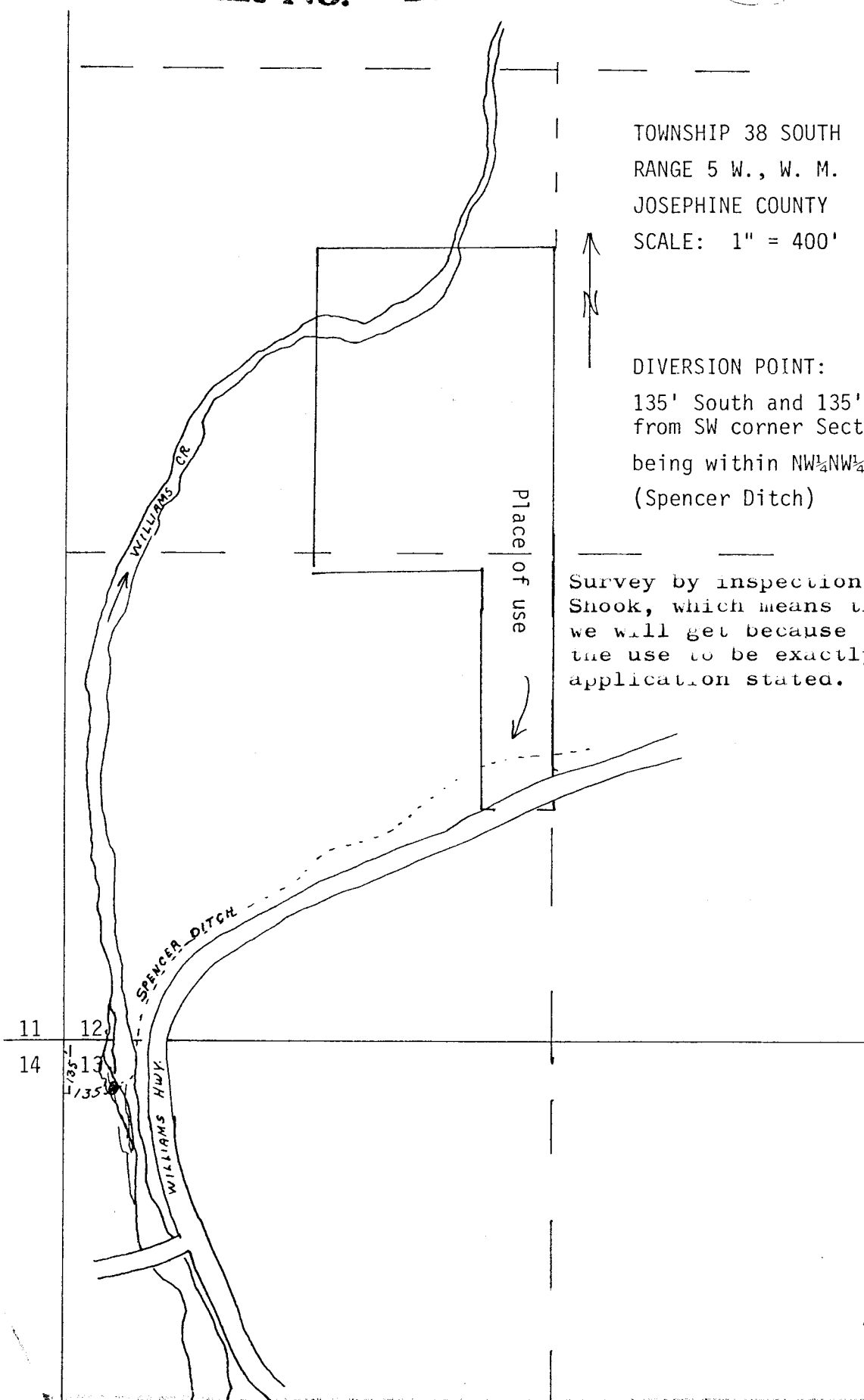

RECEIVED  
FEB 17 1978  
WATER RESOURCES DEPT.  
SALEM, OREGON