

42951
G8066

37-5-24, 25

T. 37 S., R. 5 W., W. M.

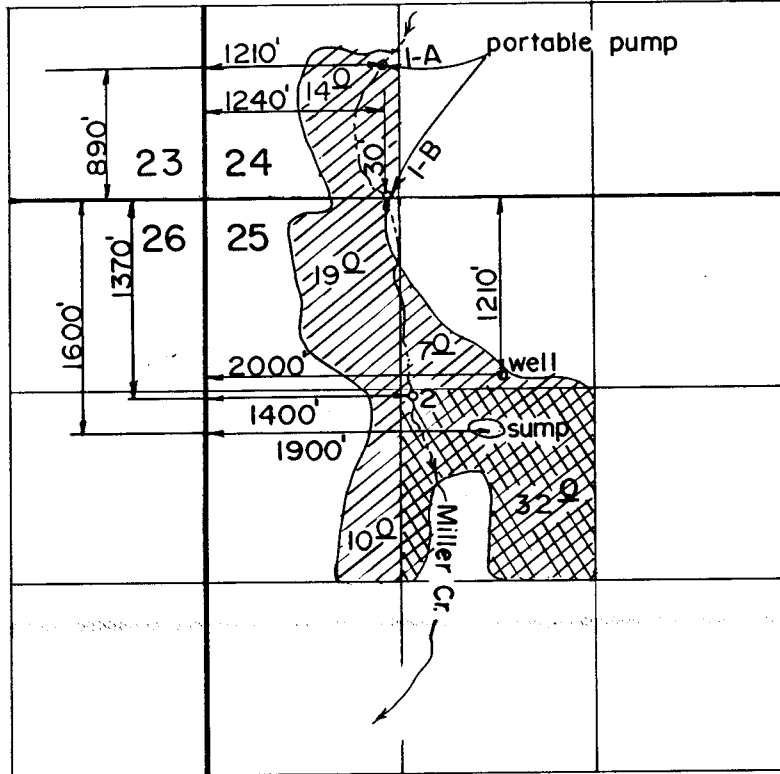

Scale: 1" = 1320'

FINAL PROOF SURVEY
UNDER

RECEIVED
APR 8 1992
REGISTRY OF LANDS
GRANTS PASS, ORE.

Application No. 57097 G-8659 Permit No. 42951 G-8066
IN NAME OF

ALBERT & ADELINE M. PONDELICK

Surveyed AUG. 23. 1988, by B. S. JAMES