

RECEIVED

MAR 8 1978

WATER RESOURCES DEPT.
SALEM, OREGON

Application No. 57148
Permit No. 42978

RECEIVED

MAR 29 1978

WATER RESOURCES DEPT.
SALEM, OREGON

SUSSLAN
NATIONAL
FOREST

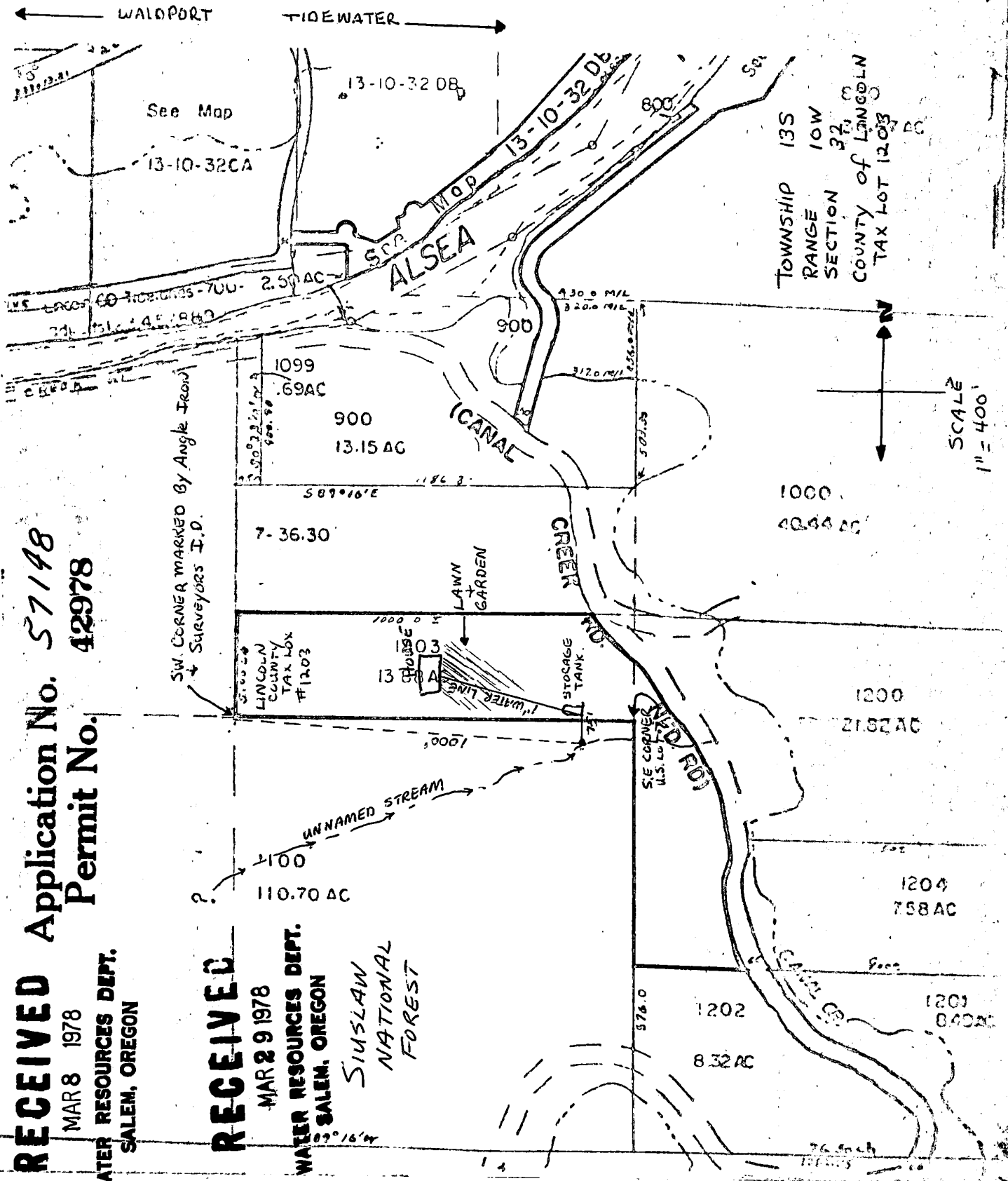

TOWNSHIP 13S
RANGE 10W
SECTION 32
COUNTY OF LINCOLN
TAX LOT 1203

SCALE
1" = 400'