

T. 9S., R. 39E., W. M.

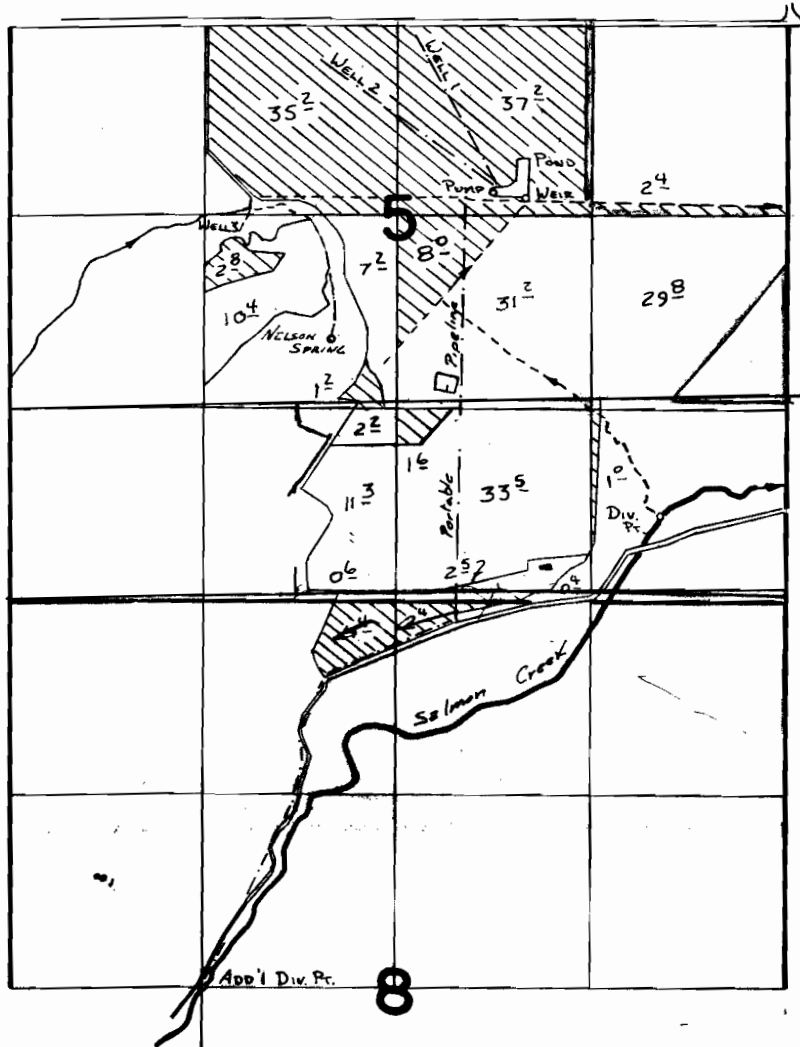

DIV. PT. LOCATED 580' N. & 850' W. FROM SE COR. SEC 5
ADD'L DIV. PT. LOC. 2640'S. & 1320'E FROM NW COR SEC 8

FINAL PROOF SURVEY
UNDER

SCALE 1" = 1320'

TRANSFERS 5279, 5280
Application No. 65168..... Permit No. 47837.....
IN NAME OF

.....JOSEPH O. RUDI.....

Surveyed MAY..23.... 19.84., by V.L. CHURCH.....

T. 9S., R. 39E., W. M.

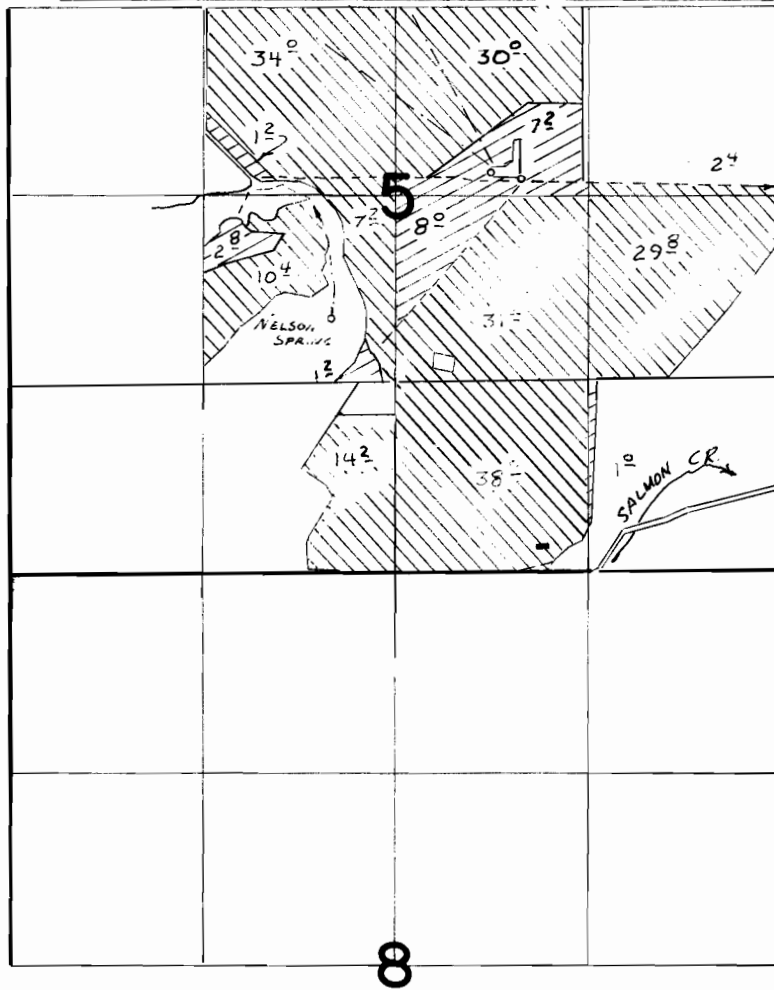

SUPP'L.



PRIM.

NELSON SPRING LOC: 850' S. & 440' W. FROM CENTER COR. SEC 5

FINAL PROOF SURVEY
UNDER

Application No. **57452** Permit No. **43376**...
IN NAME OF

.....**JOSEPH O. RUDI**.....

Surveyed ~~5-23~~..... 19~~84~~, by *V.L. Church*.....



SCALE 1" = 200'