







MAP OF EAST FORK IRRIGATION DISTRICT

TO ACCOMPANY WATER USE REPORT
PREPARED BY

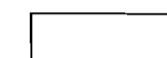
CHRIS L. WHEELER
STATE ENGINEER

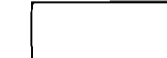
LEGEND:

-  IRRIGATED LANDS
-  LANDS CLASSIFIED AS IRRIGATED IN 1963-65 SURVEY NO LONGER USED FOR AGRICULTURAL PURPOSES
-  VESTED RIGHTS NO LONGER IRRIGATED
-  VESTED RIGHTS NO LONGER IRRIGATED EXACT LOCATION UNKNOWN
-  ADDITIONAL LANDS CLAIMED BY DISTRICT AFTER 1963-65 SURVEY
-  additional lands filed Aug. 1977
Chris L. Wheeler

SCALE: 4" = 1 MILE
(SHEET 1 OF 2)

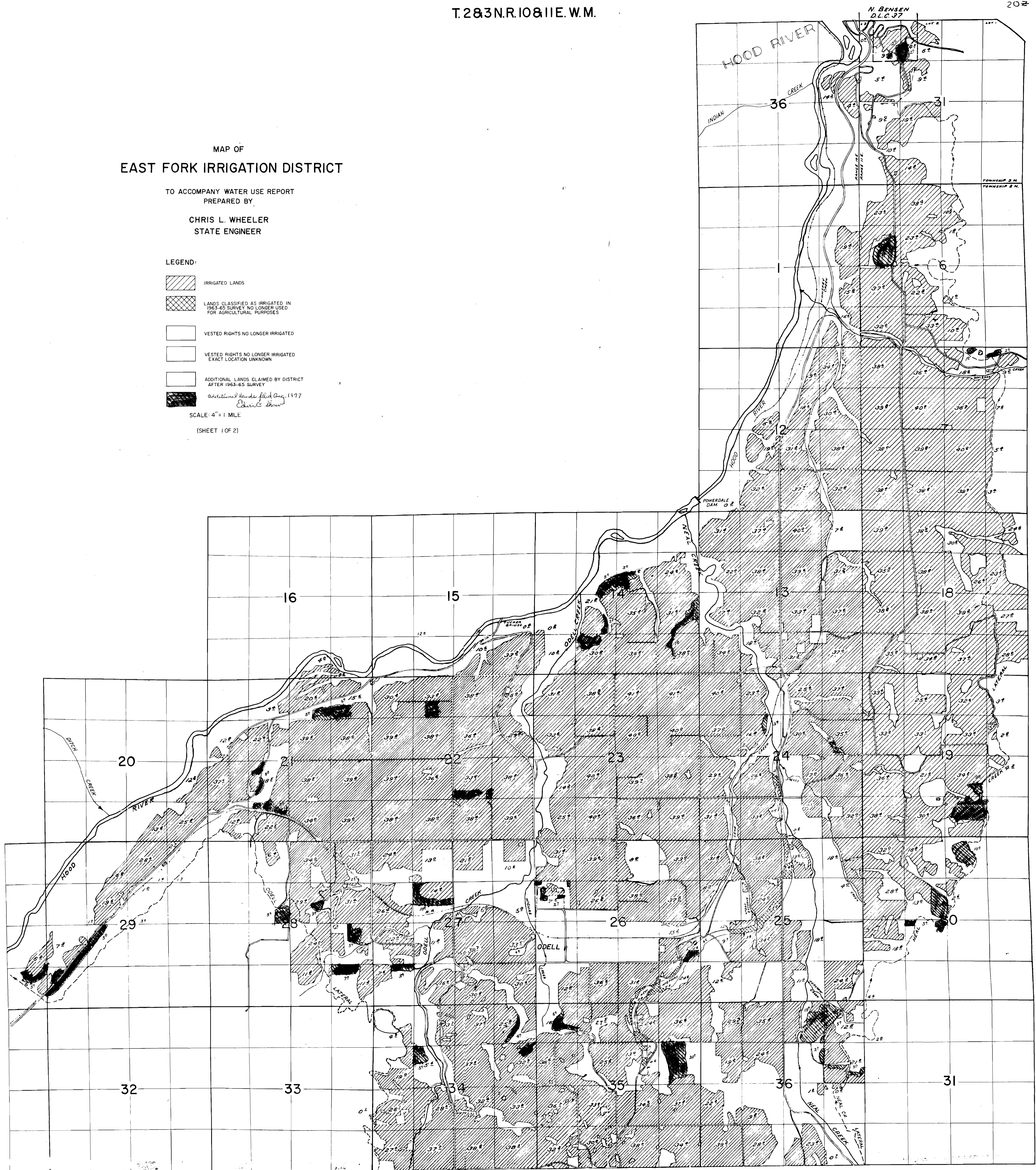

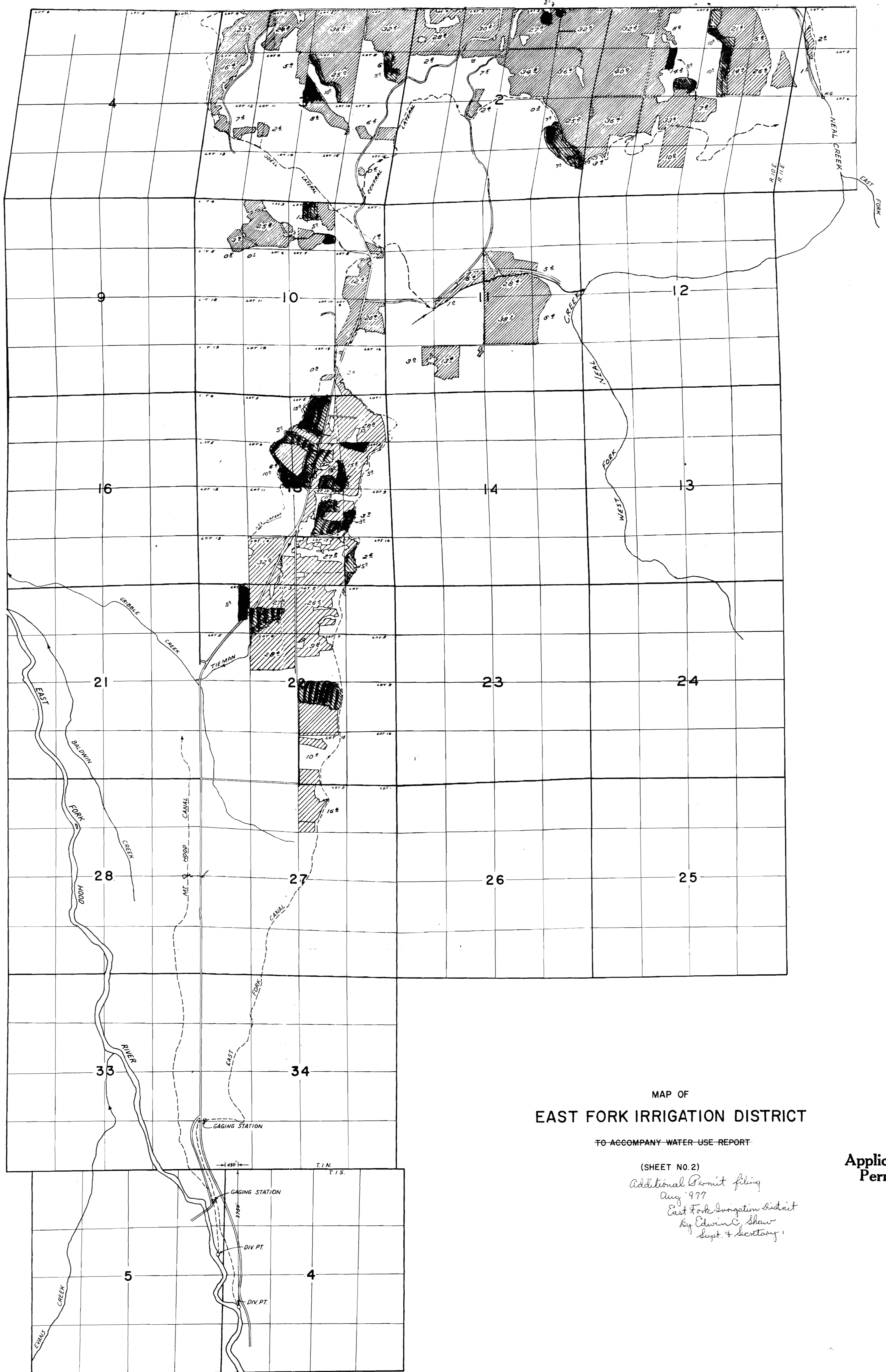

MAP OF
EAST FORK IRRIGATION DISTRICT

TO ACCOMPANY WATER-USE REPORT

(SHEET NO. 2)

*Additional Permit filing
Aug. '97
East Fork Irrigation District
by Edwin C. Shaw
Supt. & Secretary*

Application No. 56365
Permit No. 43395