

MAP

of

F. J. Kumm Water Right

CERTIFICATE OF SURVEYOR

I, A.M. Austin, of Tillamook County, Oregon, do hereby certify that this map was made from notes taken during an actual survey made by me (or under my immediate supervision) on the 22nd day of August, 1919., and that it correctly represents the works described in the accompanying application, together with the location of streams and other ditches in the immediate vicinity, and has written thereon the area in each smallest legal subdivision which it is proposed to irrigate.

A.M. Austin Surveyor.

Field Notes of Ditch.

Beginning at the Dam which is N. 68½° E. 19.50 chains and N. 14° E. 7.00 chains from the S.E. corner of section 21, T. 3. S. R. 9. W. W. M. Oregon. thence S 14° W. 7.00 chains thence S 68½° W 10.00 chains, thence N. 63° W 10.00 chains, thence S. 55° W. 15.00 chains, to end of the ditch.

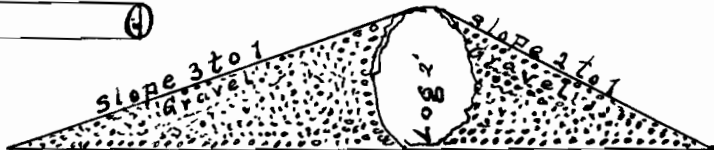
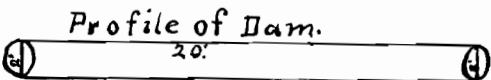
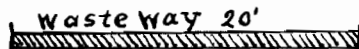
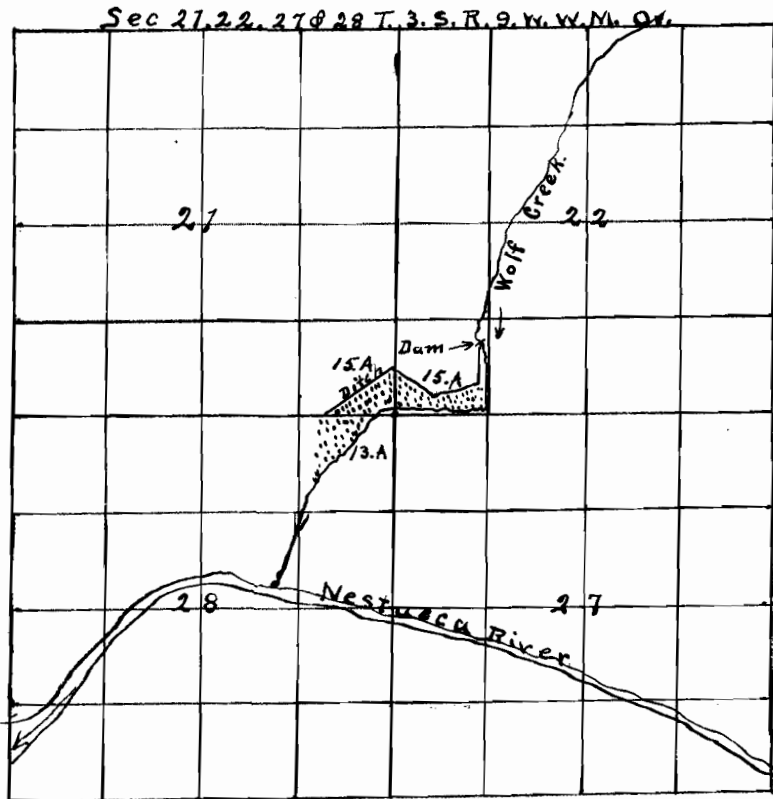

Application

6747
4345