

# T. 33 S., & T. 34 S., R. 5 W., W.M.

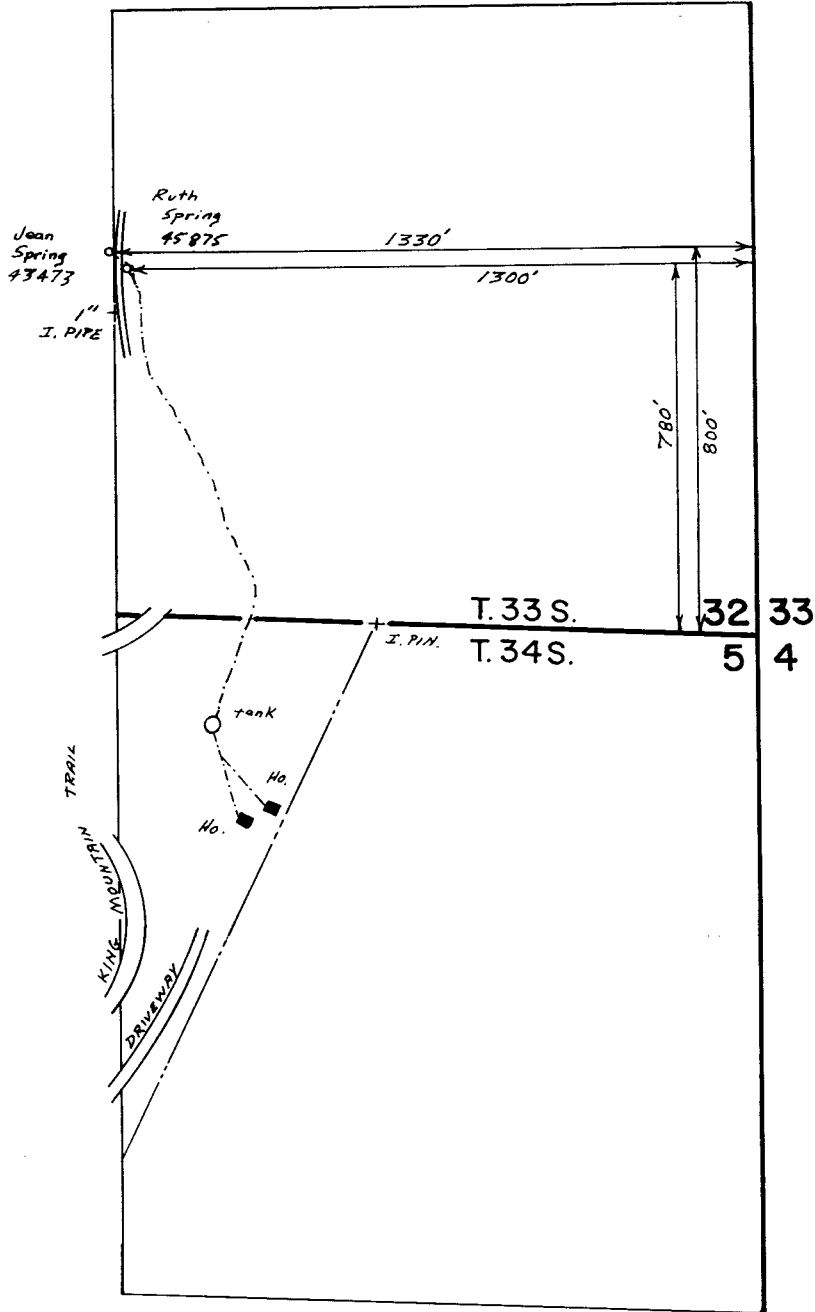

Scale 1" = 400'

JUL 14 1988

WM. DIST. 14  
GRANTS PASS, ORE

## FINAL PROOF SURVEY UNDER

57765                      43473  
Application No. 61634    Permit No. 45875  
IN NAME OF

JEAN & RUTH MOUNTAINGROVE

Surveyed Aug. 28, 1986, by B.S. JAMES