

RECEIVED

AUG 21 1978

WATER RESOURCES DEPT.
SALEM, OREGON

T. 4N. R. 37E. W.M.

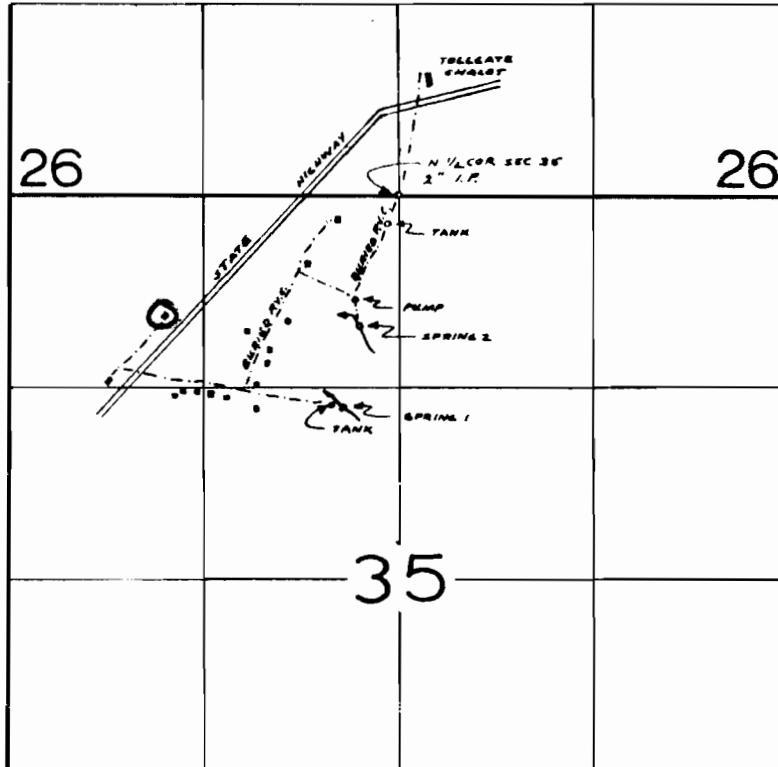

SPRING 1 LOCATED 380' W & 1400' S FROM N 1/4 COR SEC 35
SPRING 2 LOCATED 270' W & 970' S FROM N 1/4 COR SEC 35

Handwritten notes:
31
3176C
10/21/77
Stu/part 1/2
300 #2

Application No. 57869
Permit No. 43653