

Map Accompanying Application
 To appropriate Water
 Jan. 8, 1920

T. 29 S. R. 4 W. W. M.

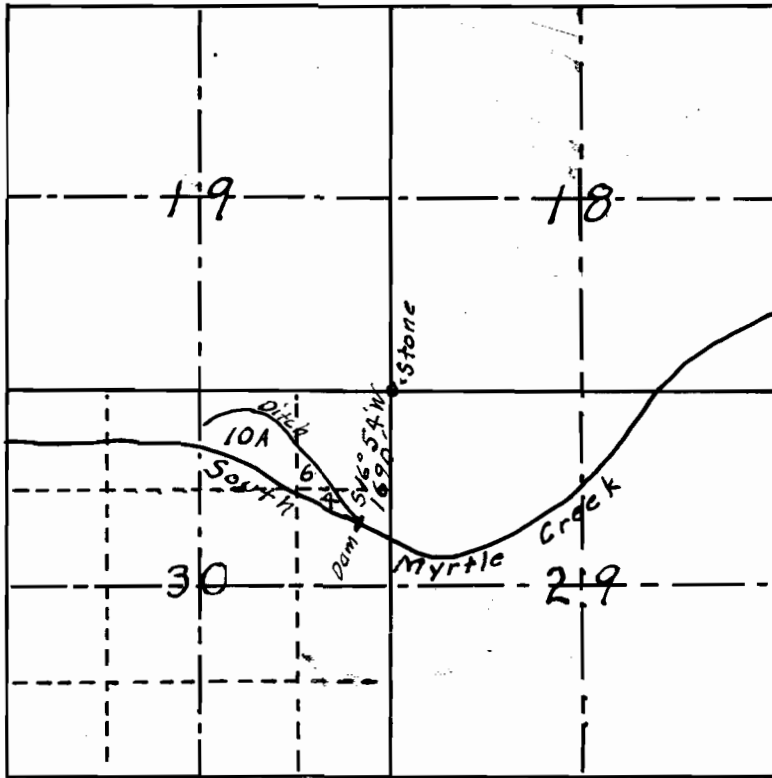

Scale 2" = 1 mile

I, David G. Glass, do hereby certify that this map was made from notes taken during an actual survey made by me on Jan 5, 1920, and that it correctly represents the works described in the accompanying application, together with the location of streams and other ditches in the immediate vicinity,

David G. Glass
 Surveyor

Profile of Dam

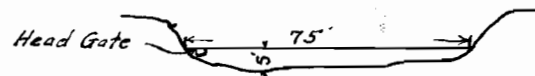

Scale 1" = 50'

X-Section of dam

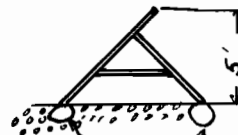

Scale 1" = 10'
 Fir logs buried in Creek bed
 "A" Frame of 6x6's set in notches in logs
 2" Planking for face of dam. Cracks battened with 1x4's
 32' in middle of stream to be removed except in irrigating season

Application No. 6983
 Permit No. 4380