

T. 41 S., R. 9 W. W.M.  
SEC. 11

RECEIVED

NOV 28 1983

WM. DIST. 14  
GRANTS PASS, OR.

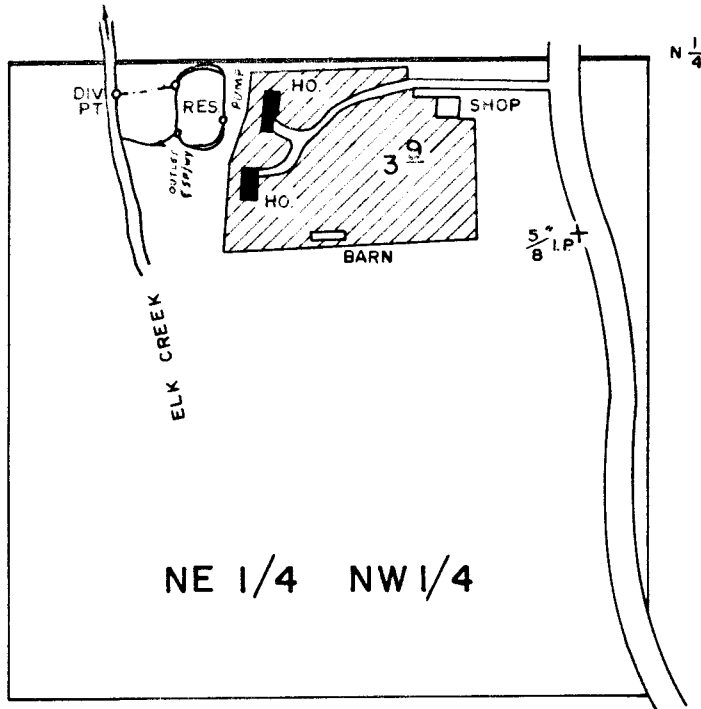

DIV. PT. : 60'S & 1100' W FROM N 1/4 COR. OF SEC. 11.  
RESERVOIR : 100'S & 920' W FROM N 1/4 COR. OF SEC. 11.

**FINAL PROOF SURVEY**  
UNDER

57887                      43841

Application No. R-58200 Permit No. R-7785...  
IN NAME OF

**JAMES R. & HARRY R. BROWN**.....

Surveyed AUG. 27, 1982, by B.R. SUND.....

Scale : 1" = 400'

PTS-1982-14A

BSJ