

838

Sup. 19 S.R. 47 E

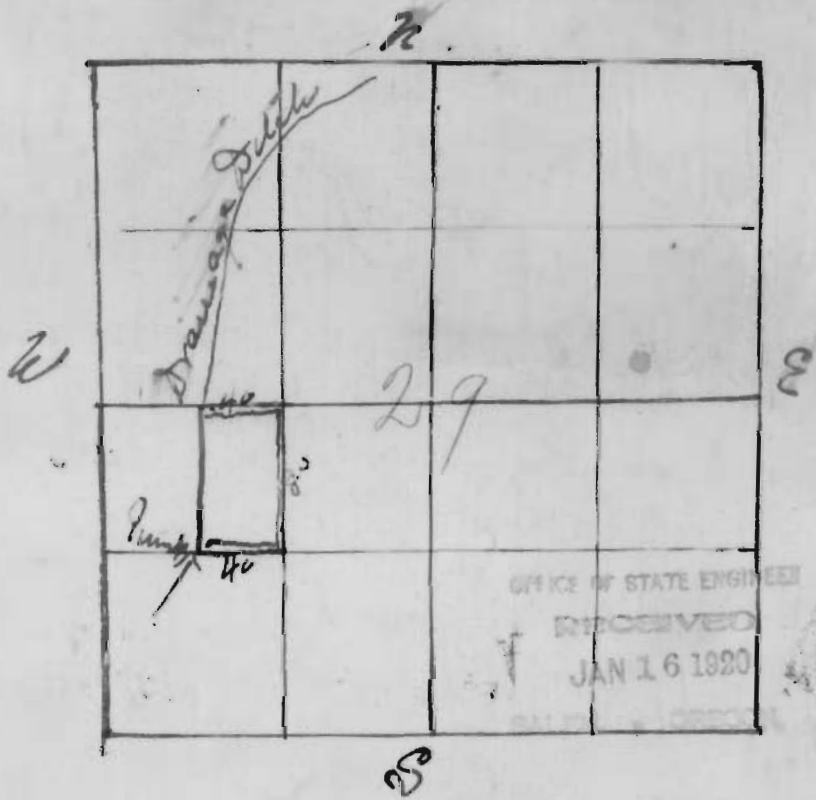

40 Rods E
 80 " W
 40 " E 6' Dish

Corrected Map

Application No. 6938
 4388



T. 19 S. R. 47 E.

18

17

16

19

20

21

30

29

28

31

32

33

Drainage ditch

Myra Goodie Drainage

Pump

Lateral 40 Rods W
80 - W
40 - W
S

OFFICE OF STATE ENGINEER

RECEIVED

DEC 15 1919

SALMON - OREGON

Superseed

Application No. 6938

Permit No. 4388