

Application No. R-56748, 56749  
Permit No. R 7791 43382

RECEIVED

OCT 13 1977

WATER RESOURCES DEPT.  
SALEM, OREGON

T. 39S., R. 19E., WM

1980

AMBERS  
THORNBERG  
S EDGE  
PARCEL OF TOWN  
↓  
FORD  
GARAGE  
A+B MEAT  
PARKING

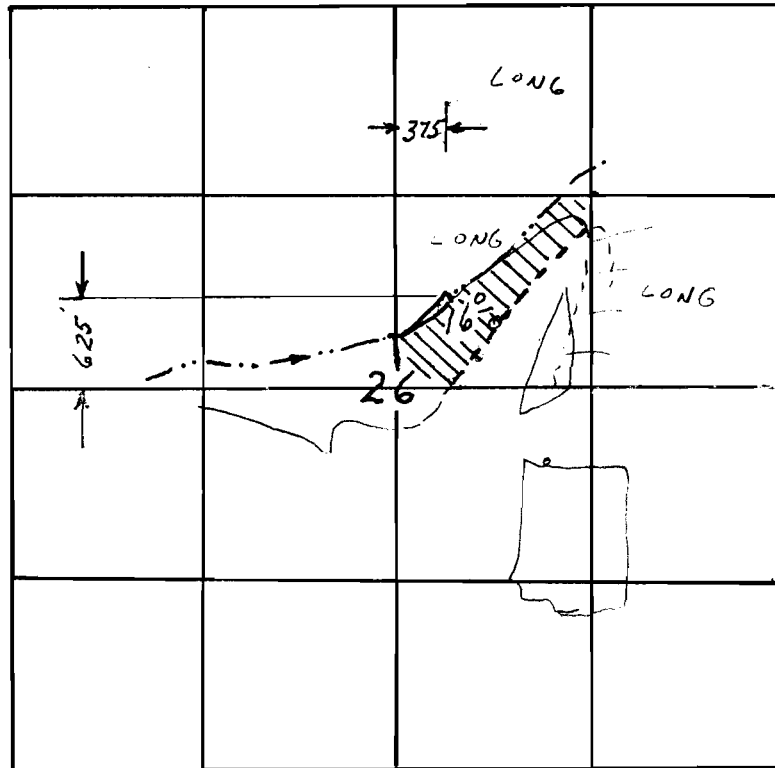

1980

1980

Scale: 4" = 1 mile  
Map approved by: Howard S. Long  
Applicant

FOR THE  
Howard S. Long  
FOR THE APPLICANT