

T.35S., R.7W., W.M.

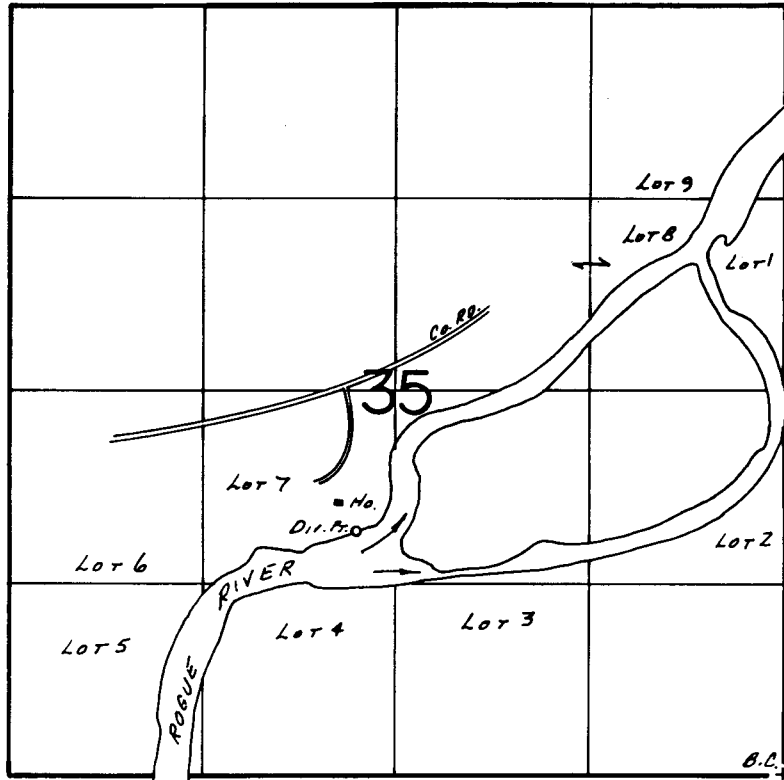

RECEIVED
SEP 1 1987
M. DIST. 14
COUNTS PAGE ONE

DIV. PT. LOC.: 1690' N. & 2900' W. FROM SE COR. SEC. 35

SCALE: 1" = 1320'

FINAL PROOF SURVEY UNDER

Application No. 58307.. Permit No. 43890.....
IN NAME OF

.....EDGAR A. IMRIE.....

Surveyed Oct. 23... 19.85, by B.S. JAMES.....

3/2/87
41033-179-166R
B.S.