

T. 38 S., R. 5 W., W.M.

RECEIVED

FEB 25 1988

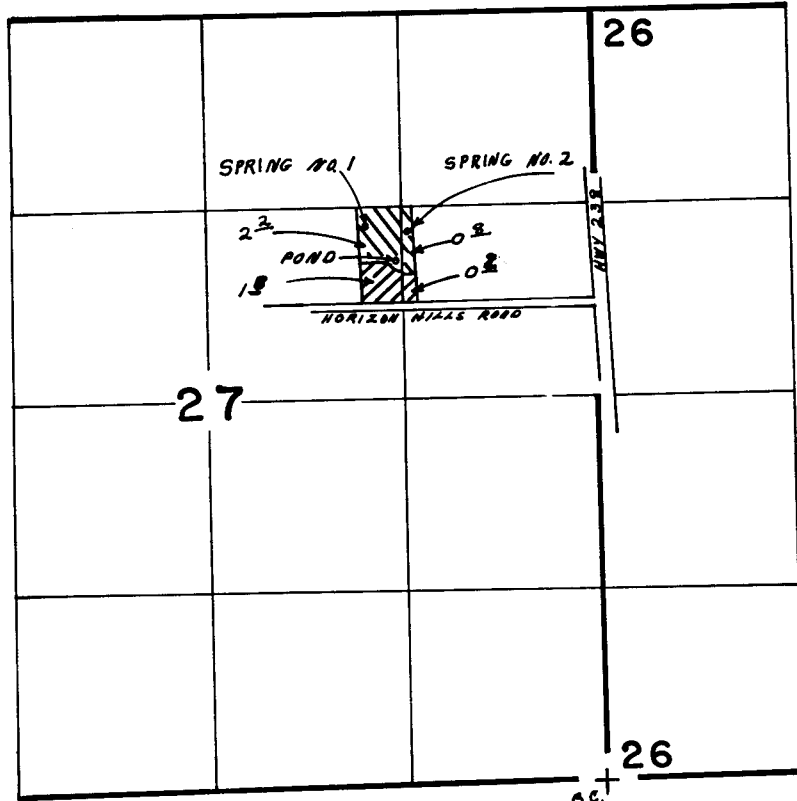

DIVERSIONS:

1= 3830' N., 1560' W.;
2=3800' N., 1250' W.;
from SE cor. Sec. 27

Scale: 1" = 1320'

FINAL PROOF SURVEY
UNDER

Application No. 58292 Permit No. 43976
IN NAME OF

DANIEL A. & MYRTLE BIGHAUS

Surveyed A.U.G. 29 1985., by B.S. JAMES....