

T. 26 S. R. 6 & 7 W. W.M.

**RECEIVED**

FEB 28 1979

**WATER RESOURCES DEPT.  
SALEM, OREGON**

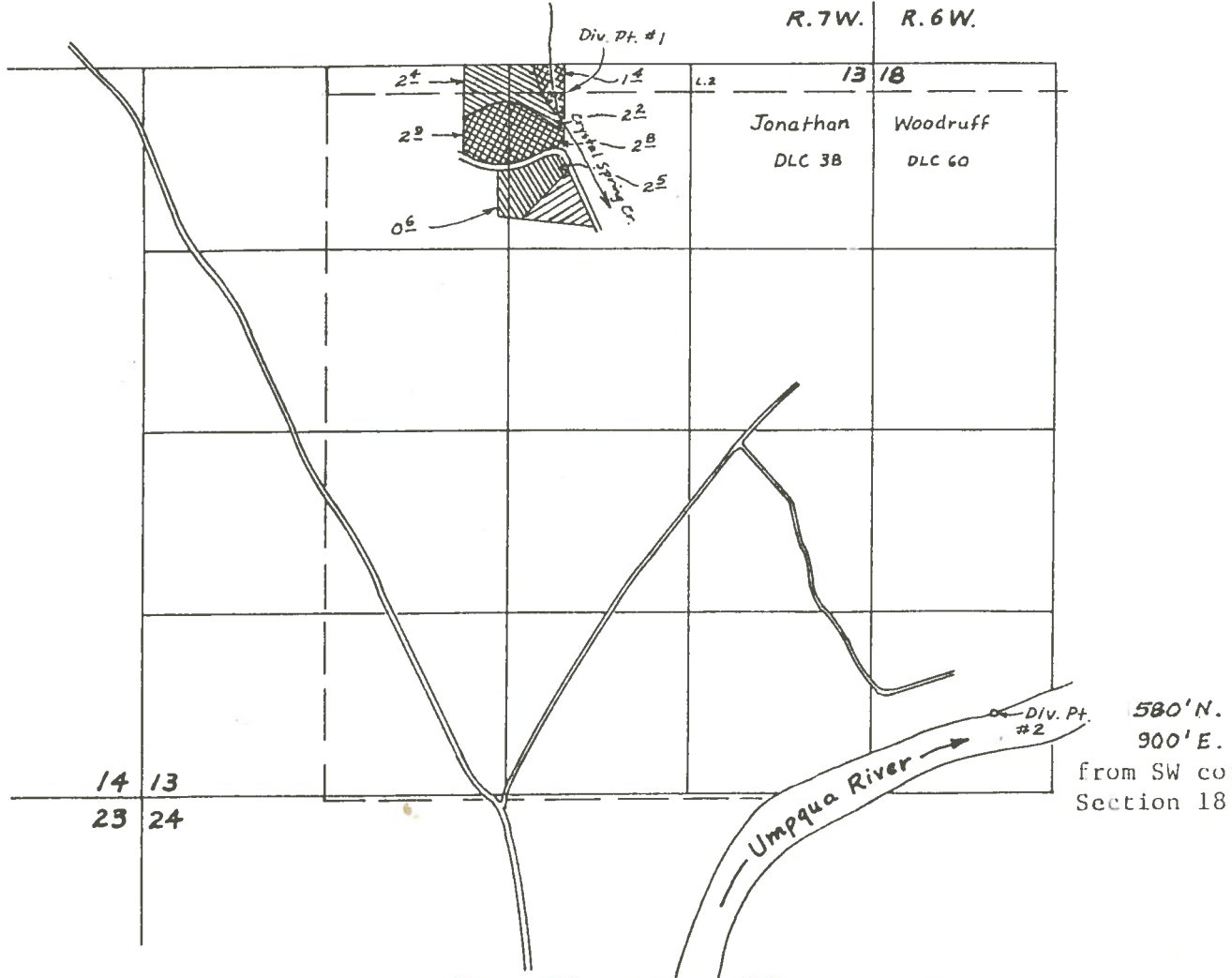

THIS MAP PREPARED BY:

*Gh Ball*

FROM INFORMATION FURNISHED BY  
THE APPLICANT.

**Application No. 58371**

**Permit No. 43985**

Scale: 4" = 1 mile



Primary from Crystal Spring Cr. & Supplemental from Umpqua R.



Primary from Umpqua R.



Portion of Permit # 36782



Portion of Permit # 36782 to be cancelled.

Div. Pt. #1 : 225'S and 320'E from N $\frac{1}{4}$  cor sec. 13.