

RECEIVED
 APR 09 1979
 WATER RESOURCES DEPT.
 SALEM, OREGON

T.29 S. R.4 W. W.M.

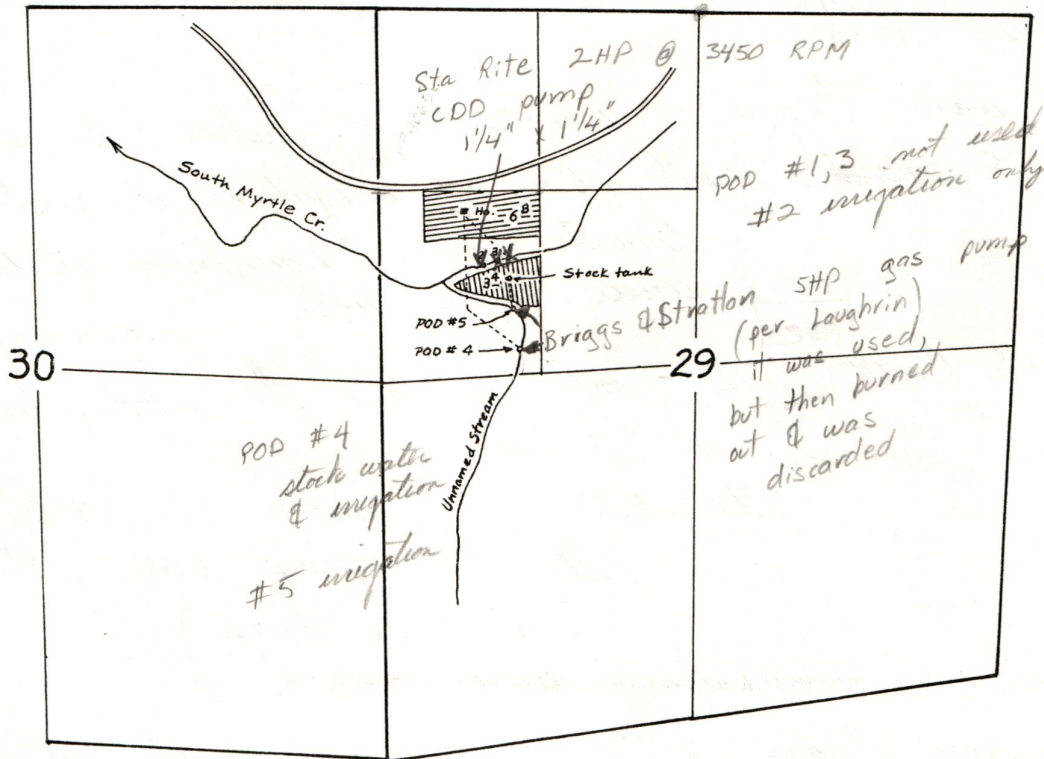

Application No. 57778
 Permit No. 44019



RB
 2" alum
 3/4", 1", 1 1/4" PVC

Laughrin
 863-4572

Scale: 4" = 1 mi.

-  To be irrigated from POD #2
-  To be irrigated from POD #5 or POD #3

- POD #1: 490' S. and 250' W.
 - POD #2: 540' S. and 425' W.
 - POD #3: 520' S. and 320' W.
 - POD #4: 1160' S. and 160' W.
 - POD #5: 960' S. and 180' W.
- } All from the NE cor. of SW $\frac{1}{4}$ NW $\frac{1}{4}$ sec. 29.